



TO LET

Bennett Close, Hounslow, TW4 5AE
£1,350 Per Calendar Month

DBK
ESTATE AGENTS

- Available To Rent 1st of April!
- Two Spacious Bedrooms
- Modern Fitted Kitchen with Integrated Appliances
- Ensuite/ Shower Room
- The Heathland School 0.3 miles
- Third Floor Apartment
- Open Plan Kitchen/ Reception Room
- Family Bathroom/ WC
- Allocated Parking Space
- Hounslow West Station 0.9 miles

619 sq.ft. (57.5 sq.m.) approx.

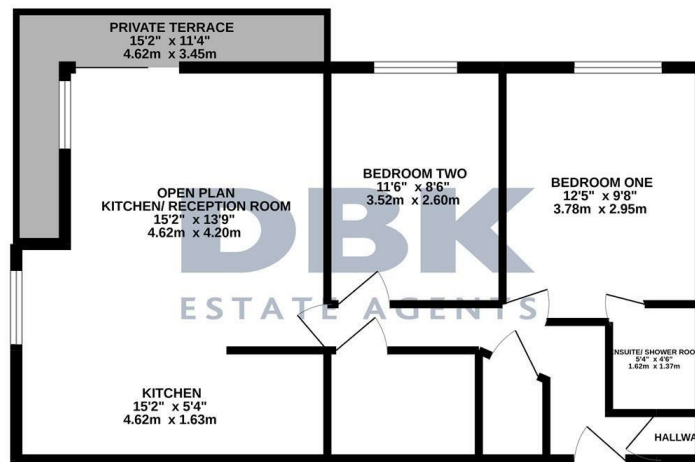

TOTAL FLOOR AREA: 619 sq.ft. (57.5 sq.m.) approx.
 Whilst every attempt has been made to ensure the accuracy of the foregoing contained here, measurements of doors, windows, rooms and any other items are approximate and no responsibility is taken for any error, omission or misstatement. This plan is for illustrative purposes only and should be used as such by any prospective purchaser. The services, systems and appliances shown have not been tested and no guarantee as to their operability or efficiency can be given.
 Made with Metropix ©2022

THE PROPERTY

Available To Rent 1st of April!

A bright and spacious third floor apartment completed with a modern interior throughout. Accommodation is arranged over 619 sq.ft with two large bedrooms (master bedroom with ensuite), a chic kitchen with integrated appliances open plan with a reception room leading to a private terrace, a stylish family bathroom suite and storage. Supplementary to this is allocated parking space, secure entry system, electric heating and communal gardens.

Situated nearby to Staines Road (TW4) the property is not short of local amenities and links into The Capital via Hounslow Overground & Underground Stations sited 0.9 miles from the property. There are also ample bus routes into Hounslow Town Centre, London Heathrow Airport and neighbouring towns as well as the A4/ A30 nearby for motorists. Local reputable schools include The Heathlands School and Hounslow Heath Junior School both scoring OUTSTANDING by OFSTED.