



TO LET

Weavers Close, Isleworth, TW7 6EH
£1,750 Per Calendar Month

DBK
ESTATE AGENTS

- Available To Rent Immediately!
- Two Bedrooms
- Reception Room
- Private Balcony
- Circa 717 Sq.Ft
- Split-Level Maisonette
- Separate Kitchen
- Chic Bathroom
- Storage Solutions
- Modernised + Well Presented Throughout

THE PROPERTY

Available to rent immediately is this beautifully presented and modernised two-bedroom split-level maisonette, offering approximately 717 sq. ft. of bright and well-proportioned accommodation.

The property further comprises a spacious reception room, a separate fitted kitchen, a stylish contemporary bathroom and storage.

Further benefits include a private balcony, providing a pleasant outdoor space to relax and unwind.

Set within a quiet residential cul-de-sac situated in the heart of Isleworth, offering excellent access to local amenities, reputable schools and convenient transport links. The property is ideally positioned within easy reach of Isleworth town centre, a variety of shops, cafés and supermarkets, whilst the open green spaces of Syon Park and the River Thames are also nearby. Excellent connectivity is provided via Isleworth and Hounslow East stations, alongside regular bus routes and easy access to the A4, M4 and Heathrow Airport, making this an ideal location for commuters.

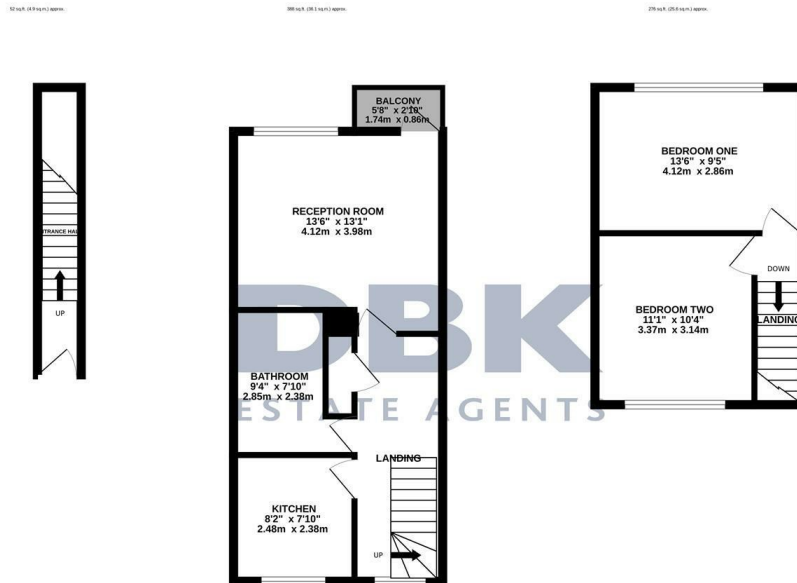

TOTAL FLOOR AREA: 717 sq. ft. (66.6 sq.m.) approx.

Whilst every attempt has been made to ensure the accuracy of the description contained herein, measurements of doors, windows, rooms and any other items are approximate and no responsibility is taken for any error, omission or misstatement. This plan is for illustrative purposes only and should be used as such by any prospective purchaser. The services, systems and appliances shown have not been tested and no guarantee is given as to their operability or efficiency can be given.

Made with Metropax ©2026