



# TO LET

**Ellington Road, Hounslow, TW3 4HX**  
**£1,600 Per Calendar Month**

**DBK**  
ESTATE AGENTS

- Available To Rent Immediately! ▪ ALL BILLS INCLUDED!
- Ground Floor Apartment ▪ One Double Bedroom
- Sizeable Reception Room ▪ Fitted Kitchen
- Shower Room/ WC ▪ Off-Street Parking
- Hounslow East Underground Station 0.3 miles ▪ Hounslow Central Underground Station 0.3 miles

GROUND FLOOR  
425 sq.ft. (39.5 sq.m.) approx.

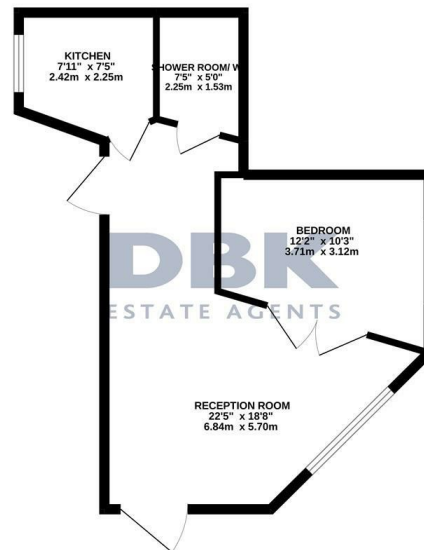

TOTAL FLOOR AREA: 425 sq.ft. (39.5 sq.m.) approx.  
While every attempt has been made to ensure the accuracy of the floorplan contained herein, measurements of floor, window, doors and any other items are approximate and no responsibility is taken for any errors, omissions or mis-statements. This plan is for illustrative purposes only and should be used as such by any prospective purchaser. The services, systems and appliances shown have not been tested and no guarantee can be given for their operation or efficiency can be given.  
Made with Mapbox (2022)

## THE PROPERTY

Available To Rent immediately! ALL BILLS INCLUDED!

A spacious ground floor apartment ideal for any single person or couple. Accommodation comprises of one double bedroom, an open plan kitchen/ reception area and a chic shower room/ WC. Complementary to this is off-street parking, access to a garden, central heating and double glazed windows.

Undoubtedly located in a prime location of Hounslow with just moments of a walk to Hounslow East Station (Piccadilly line) and the 24 Hour Asda Superstore. Also situated a stones throw away are a magnitude of amenities including the Treaty shopping centre, restaurants and bars places on Hounslow High Street. Reputable schools such as Spring Grove Primary School and Lampton Academy both scoring OUTSTANDING by OFSTED.