



TO LET

Heath Road, Hounslow, TW3 2NB
£1,700 Per Calendar Month

DBK
ESTATE AGENTS

- Available To Rent Mid-August!
- Two Bedrooms
- Modern Fitted Kitchen
- Ample Storage
- Prime Location
- Second Floor Apartment
- Bright Reception Room
- Stylish Family Bathroom/ WC
- Secure Entry System
- Hounslow Station within walking distance

603 sq.ft. (56.0 sq.m.) approx.

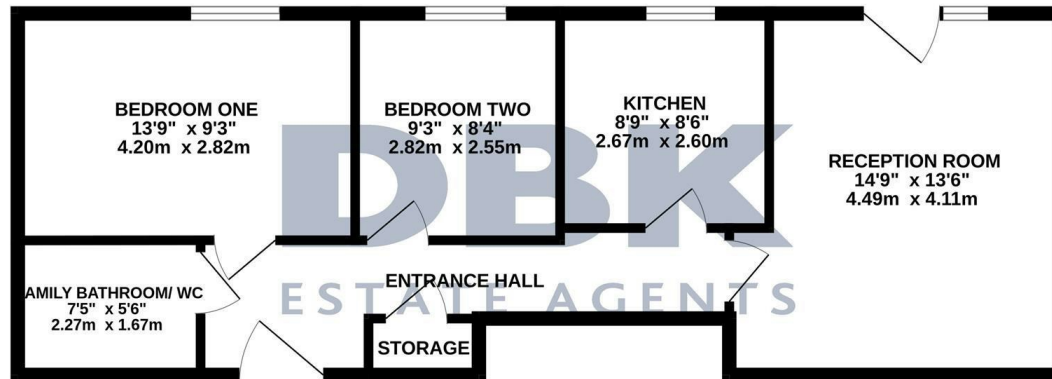

TOTAL FLOOR AREA: 603 sq.ft. (56.0 sq.m.) approx.

Whilst every attempt has been made to ensure the accuracy of the floorplan contained here, measurements of doors, windows, rooms and any other items are approximate and no responsibility is taken for any error, omission or mis-statement. This plan is for illustrative purposes only and should be used as such by any prospective purchaser. The services, systems and appliances shown have not been tested and no guarantee as to their operability or efficiency can be given.
Made with Metropix ©2024

THE PROPERTY

Available To Rent Mid-August!

Discover this charming second-floor apartment situated in a prime location, perfect for modern living. This thoughtfully designed property boasts two well-proportioned bedrooms, ideal for families and professionals. The bright and inviting reception room offers a comfortable space to relax and entertain.

The apartment features a modern fitted kitchen, equipped with contemporary appliances, making meal preparation a breeze. The stylish family bathroom/WC is elegantly finished to meet all your needs. With ample storage throughout, staying organized is effortless.

Located in the heart of Hounslow, 16 Candle Court offers exceptional convenience and connectivity. Hounslow Station is within walking distance, with nearby Underground stations (Piccadilly Line) providing swift links to Heathrow Airport and Central London. Major roads like the A4 and M4 are easily accessible for drivers.

Enjoy the vibrant Hounslow High Street, with its array of shops, restaurants, and amenities, and relax in nearby green spaces like Inwood Park and Hounslow Heath. The area also offers excellent schools and community facilities, making it ideal for families.