

# TO LET

Convent Way, Southall, UB2 5UE  
£1,700 Per Calendar Month

**DBK**  
ESTATE AGENTS

- Available To Rent Immediately! ▪ Newly Refurbished!
- Third Floor Apartment (No Lift) ▪ Two Double Bedrooms
- Large Reception Room ▪ Brand New Modern Fitted Kitchen
- Family Bathroom/ WC ▪ Secure Entry System
- Ample Storage ▪ Southall Overground Station 1.1 mile

THIRD FLOOR  
688 sq.ft. (64.0 sq.m.) approx.

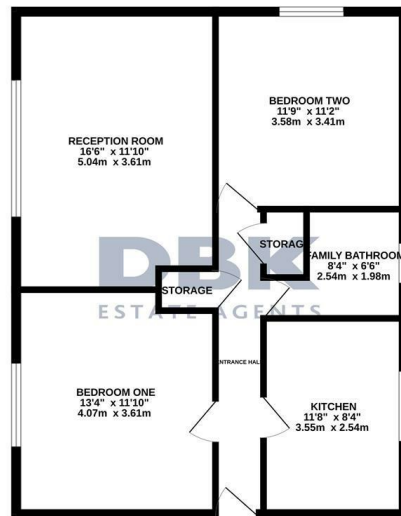

TOTAL FLOOR AREA: 688 sq.ft. (64.0 sq.m.) approx.  
While every attempt has been made to ensure the accuracy of the brochure contained herein, measurements of floors, windows, doors and any other items are approximate and no responsibility is taken for any errors, omissions or misstatements. This plan is for illustrative purposes only and should be used as a guide for any prospective purchaser. The services, systems and appliances shown have not been tested and no guarantee is given for their operation or efficiency can be given.  
Made with Metaplan 12/25

## THE PROPERTY

Available to Rent Immediately!

This beautifully refurbished third-floor apartment (please note: no lift) offers bright, spacious, and modern living in a convenient Southall location.

Inside, you'll find two generous double bedrooms, a large reception room perfect for relaxing or entertaining, and a brand-new fitted kitchen with sleek cabinetry and integrated appliances. There's also a stylish family bathroom/WC and ample built-in storage throughout.

With fresh interiors and a well-designed layout, this home is ready for immediate occupancy. The building benefits from a secure entry system, and the apartment is ideally positioned close to local shops and amenities.

Located in the heart of Southall, UB2 offers great convenience and a lively community atmosphere. Local shops, supermarkets, cafés, and Southall Broadway are close by, providing everything you need day to day. For commuters, Southall Station (Overground & Elizabeth Line) is around 1.1 miles away, with excellent links to Central London and Heathrow. There are also good bus routes and easy access to the A312, A40, and M4.