



# TO LET

Featherstone Road, Southall, UB2 5AQ  
£2,300 Per Calendar Month

**DBK**  
ESTATE AGENTS

- Available To Rent Immediately!
- Newly Refurbished Semi-Detached House
- Two Spacious Reception Rooms
- Ground Floor Bathroom/ WC
- Three Sizeable Bedrooms
- Family Shower Room/ WC
- Rear Garden
- Ample Storage
- Street Parking Available (Permit Required)
- Southall Station 0.5 Miles

## THE PROPERTY

Available To Rent Immediately!

This newly refurbished three bedroom semi detached home has been finished to a high standard throughout, offering bright and spacious accommodation ideal for families and professional tenants alike.

The ground floor features two generous reception rooms, providing flexible living and dining space, alongside a modern bathroom/WC. The property also benefits from ample storage throughout, ensuring practicality for everyday living.

Upstairs, there are three sizeable bedrooms and a contemporary family shower room/WC, offering comfortable accommodation for the whole household.

Externally, the property boasts a private rear garden, perfect for outdoor relaxation and entertaining. Street parking is available by permit.

Conveniently situated just 0.5 miles from Southall Station, the property offers excellent transport links, as well as easy access to local amenities, schools, and shopping facilities.

Early viewing is highly recommended to appreciate all this beautifully refurbished home has to offer.

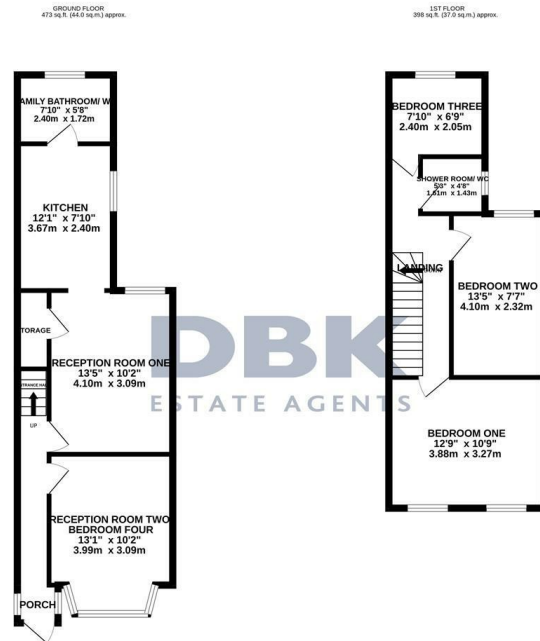

TOTAL FLOOR AREA: 871 sq. ft. (80.9 sq. m.) approx.  
While every attempt has been made to ensure the accuracy of the floorplan contained here, measurements of floors, windows, doors and any other items are approximate and the responsibility is taken for any error. Conditions or other matters. This plan is for illustrative purposes only and should be used as a guide only for prospective purchasers. The services, systems and appliances shown here are not tested and no guarantee as to their operability or efficiency can be given.  
 Made with Metronix i2020