



# TO LET

**Nield Road, Hayes, UB3 1SE**  
**£1,500 Per Calendar Month**

**DBK**  
ESTATE AGENTS

- Available To Rent Immediately!
- End of Terrace House
- Three Bedrooms
- Two Reception Rooms
- Kitchen
- Family Bathroom/ WC
- Rear Garden with Side Gated Access
- On Street Parking
- Hayes & Harlington Overground Station (0.2 mi)
- Walking Distance to Hayes Town

## THE PROPERTY

Available To Rent Immediately!

A well presented end of terrace house comprising of three bedrooms, two reception rooms, kitchen, family bathroom/WC. Other features include a rear garden with side gated access, gas central heating and double-glazed windows and on street parking.

The property is ideally located within walking distance to Hayes and Harlington Station for those commuting to The City as well as being close to Hayes Town providing an ample array of local amenities ranging from Lidl to leisure facilities. The property also falls within the catchment of Local reputable schools.

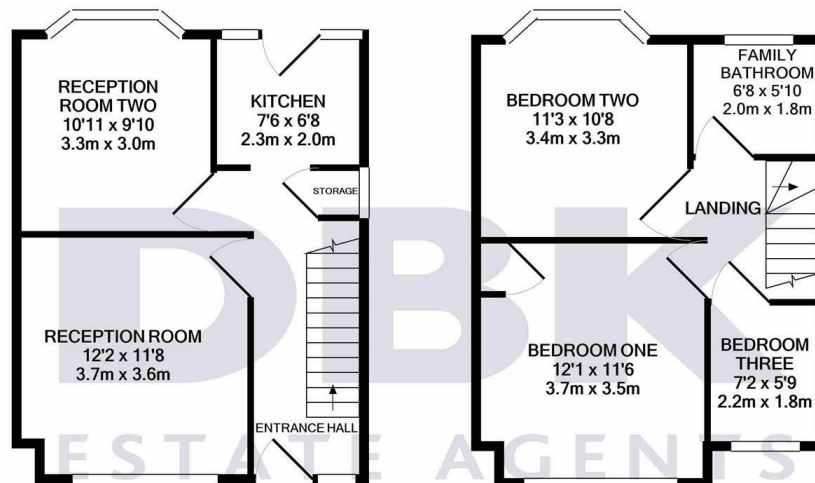

GROUND FLOOR  
APPROX. FLOOR  
AREA 386 SQ.FT.  
(35.8 SQ.M.)

1ST FLOOR  
APPROX. FLOOR  
AREA 376 SQ.FT.  
(34.9 SQ.M.)

TOTAL APPROX. FLOOR AREA 761 SQ.FT. (70.7 SQ.M.)

Whilst every attempt has been made to ensure the accuracy of the floor plan contained here, measurements of doors, windows, rooms and any other items are approximate and no responsibility is taken for any error, omission, or mis-statement. This plan is for illustrative purposes only and should be used as such by any prospective purchaser. The services, systems and appliances shown have not been tested and no guarantee as to their operability or efficiency can be given.  
Made with Metropix ©2021