



**TO LET**

**Northfield Road, Heston, TW5 9JQ  
£1,750 Per Calendar Month**

**DBK**  
ESTATE AGENTS

- Available To Rent Mid-August!
- Two Double Bedrooms
- Sizeable Stylish Fitted Kitchen
- Fitted Wardrobes
- Berkeley Academy 0.2 miles
- Modern First Floor Apartment!
- Large Reception Room
- Chic Family Bathroom/ WC
- Private Balcony
- Hounslow West Underground Station 0.9 miles

730 sq.ft. (67.8 sq.m.) approx.

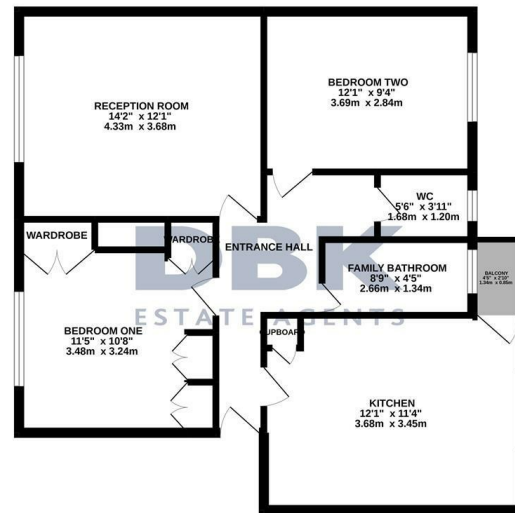

TOTAL FLOOR AREA: 730 sq ft, (67.8 sq m) approx.  
 While every effort has been made to ensure the accuracy of the floorplan contained herein, measurements of space, finishes, fixtures and any other items are approximate and are intended to guide the prospective purchaser. The landlord, agent and any other persons are not responsible for any errors or omissions of this statement. This plan is for illustrative purposes only and should be used as such by the prospective purchaser. The landlord, agent and any other persons are not responsible for any errors or omissions of this statement.  
 Made with Metaphor ©2022

## THE PROPERTY

Available To Rent Mid-August!

This modern first floor apartment offers a modern and stylish living space in a highly convenient location.

The property boasts two generously sized double bedrooms, both with fitted wardrobes, and a chic family bathroom/WC. A large reception room provides the perfect setting for relaxation or entertaining, while the sizeable, contemporary fitted kitchen offers ample space for dining and day to day living.

Adding further appeal, the apartment benefits from a private balcony, ideal for enjoying outdoor space in a more private setting.

This property, set within the desirable TW5 area just 0.2 miles from Berkeley Academy, it provides easy access to well regarded local schooling. For those travelling into central London or Heathrow, Hounslow West Underground Station is less than a mile away, connecting directly via the Piccadilly Line. The surrounding neighbourhood offers a range of everyday amenities, local shops, and green spaces, ensuring a balance of practicality and lifestyle.