



# TO LET

**Welland Close, Slough, SL3 8UP**  
**£1,600 Per Calendar Month**

**DBK**  
ESTATE AGENTS

- Available To Rent Immediately!
- Ground Floor Apartment
- Two Double Bedrooms
- Fitted Kitchens
- Large Reception Room
- Family Bathroom/ WC
- Fitted Wardrobes
- Communal Gardens
- Foxborough Primary School 0.2 miles
- Langley Station 1.2 miles

GROUND FLOOR  
617 sq.ft. (57.3 sq.m.) approx.

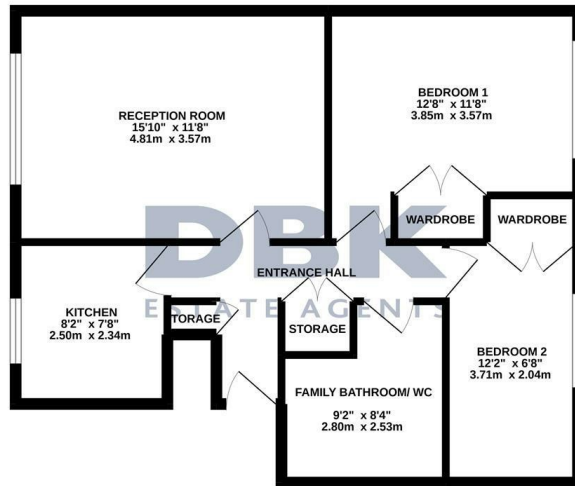

TOTAL FLOOR AREA: 617 sq.ft. (57.3 sq.m.) approx.  
Whilst every attempt has been made to ensure the accuracy of the floorplan contained herein, measurements of rooms, corridors, stairs and any other areas are approximate and no responsibility is taken for any error.  
Dimensions of this residence, the plan is for illustrative purposes only and should be used as a guide only for prospective purchasers. The services, systems and appliances shown have not been tested and no guarantee is given as to their operability or efficiency can be given.  
Made with Moraxon 12/2022

## THE PROPERTY

Available To Rent Immediately!

A superb ground floor apartment situated within a cul de sac. Accommodation compromises of two double bedrooms, a large reception room, fitted kitchen and sizeable family bathroom/ wc. Supplementary to this is fitted wardrobes, ample storage, communal gardens, on-street parking and gas central heating.

Council Tax Band C

Sited just a short distance from Heathrow Airport the property lies close to an array of local amenities including convenience stores, restaurants, pubs, cafes and local pharmacy as well as being in the catchment for local primary and secondary schools. Heathrow Terminal 5 Station is within 2 miles from the property ideal for those commuting to The City. The property is situated within a close proximity to the M25, M4 and A4, connecting those commuting into Heathrow, The City and The West.