



2 Furzecroft Percy Avenue, Ashford, TW15 2PD

£1,500 Per Month

2 Furzecroft Percy Avenue, Ashford, TW15 2PD

Ideally located for the High Street, Schools and Ashford Train Station this ground floor apartment has been redecorated throughout and new flooring laid. The apartment has two bedrooms, large lounge, modern bathroom, modern kitchen with direct access to a private garden and large decked area. Available 20th June, please call for more information and to arrange a viewing.



Floor Plan

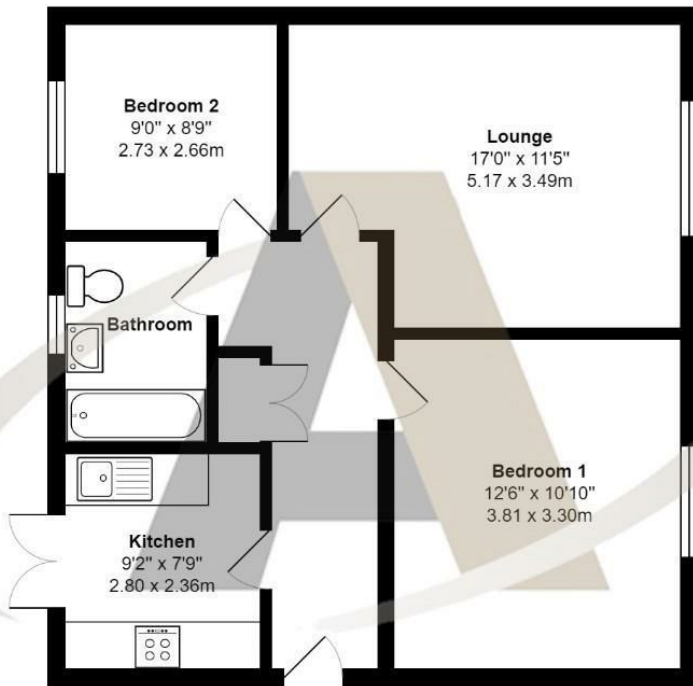

Furzecroft, Percy Ave, Ashford

Total Area: 715 ft² ... 66.4 m²
All measurements are approximate and for display purposes only



Features

- Redecorated Throughout
- Two Bedrooms
- Modern Bathroom
- New Flooring
- Private Garden
- Available 20th June
- Modern Kitchen
- Large Lounge
- Ground Floor
- Unfurnished

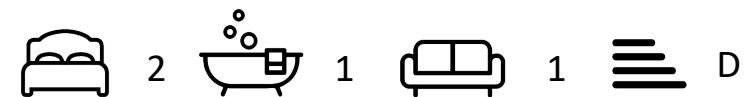

Tenure - Council Tax Band -

