



INCORPORATING
Waterford's
Residential Sales & Lettings

9 Douglas Road, Addlestone, KT15 2DZ

£290,000

9 Douglas Road, Addlestone, KT15 2DZ

A well-presented two-bedroom split-level maisonette situated in the ever-popular Douglas Road, Addlestone, overlooking Victory Park and conveniently located for local schools, transport links, and everyday amenities. The property is also within a short walk of the Addlestone One development, offering a cinema, restaurants, and a variety of shops.

The accommodation comprises two double bedrooms, a modern shower room, and a spacious lounge leading through to a conservatory, which opens onto a pretty yet low-maintenance garden, perfect for relaxing or entertaining.

Further benefits include a long lease and low service charges, making this an ideal purchase for first-time buyers, downsizers or investors alike. Sensibly priced and offering the feel of a house, this property must be viewed to be fully appreciated.

Contact Aspen Estate Agents today to arrange your viewing.



Floor Plan

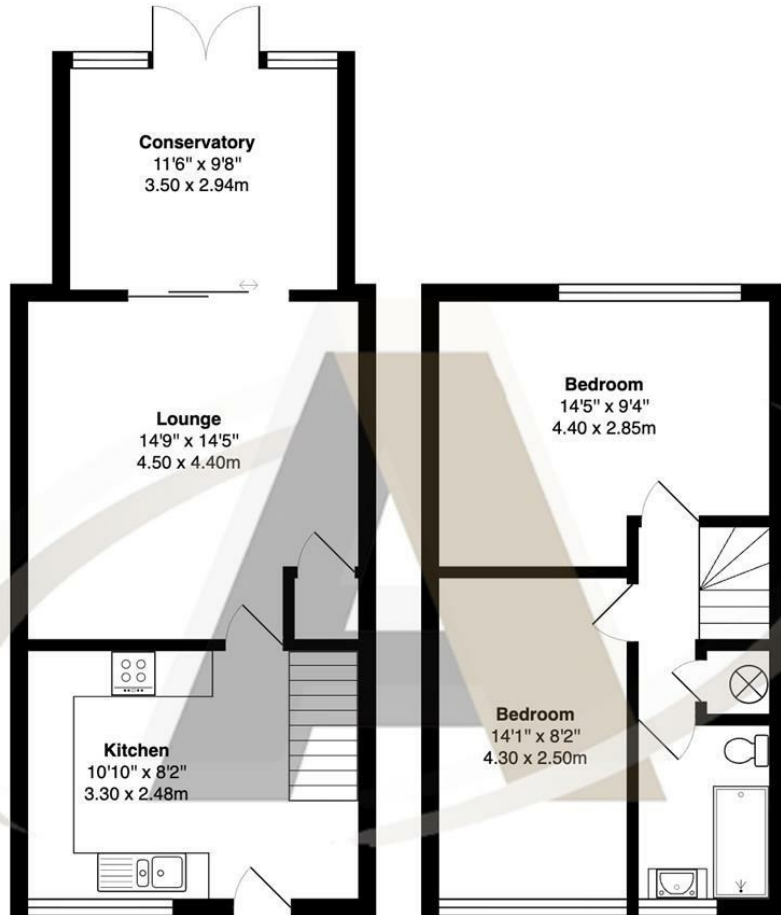

Douglas Road, Addlestone

Total Area: 873 ft² ... 81.1 m²
 All measurements are approximate and for display purposes only

Aspen Estate Agents incorporating Waterfords

32 High Street
 Chobham
 Surrey
 GU24 8AA
 01276 858 589
 chobham@waterfords.co.uk



Features

- Two-bedroom split-level maisonette in the ever-popular Douglas Road, Addlestone overlooking Victory Park
- Spacious accommodation comprising two double bedrooms and a modern shower room
- Long lease and low service charges, ideal for first-time buyers, downsizers or investors
- Conveniently located for local schools, transport links and amenities, including The Addlestone One with cinema, shops and restaurants nearby
- Large lounge leading to conservatory with access to a pretty, low-maintenance garden
- Sensibly priced home offering a house-like feel — contact Aspen Estate Agents to arrange a viewing

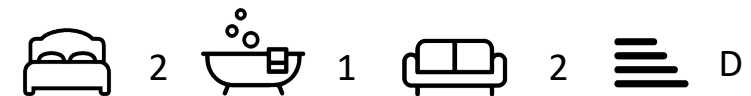

Tenure - Leasehold Council Tax Band - C

