



3 Trinity Wood, West End, Woking, GU24 9BW

INCORPORATING
Waterford's
Residential Sales & Lettings

£575,000

3 Trinity Wood, West End, Woking, GU24 9BW

Located in the popular Trinity Wood in West End, Woking, this detached house offers a perfect blend of comfort and elegance. With three well-proportioned bedrooms, this property is ideal for families and remains conveniently close to local amenities.

Upon entering, you are greeted by a spacious reception room that provides a warm and inviting atmosphere, perfect for both relaxation and entertaining guests. The layout of the house ensures that each bedroom is generously sized, allowing for personal space and comfort. Additionally, the property boasts an en-suite shower room to the master bedroom, a family bathroom and downstairs wc.

The surrounding area of Trinity Wood is known for its picturesque landscapes and tranquil environment, making it an ideal location for those who appreciate nature and outdoor activities. With excellent transport links and local schools nearby, this property is not only a beautiful home but also a practical choice for families.

This detached house in Trinity Wood is a rare find, offering both style and functionality in a sought-after location.

This property is already creating great interest so prompt viewings are encouraged and can be booked by calling Waterfords Estate Agents.



Floor Plan

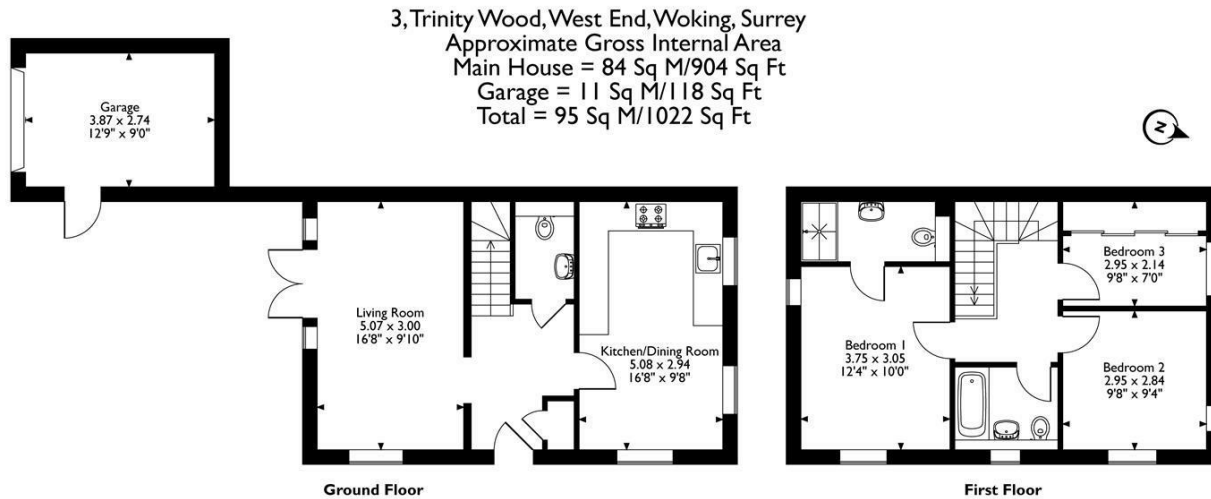

Please note that the location of doors, windows and other items are approximate and this floorplan is to be used for illustrative purposes only. Unauthorized reproduction is prohibited.

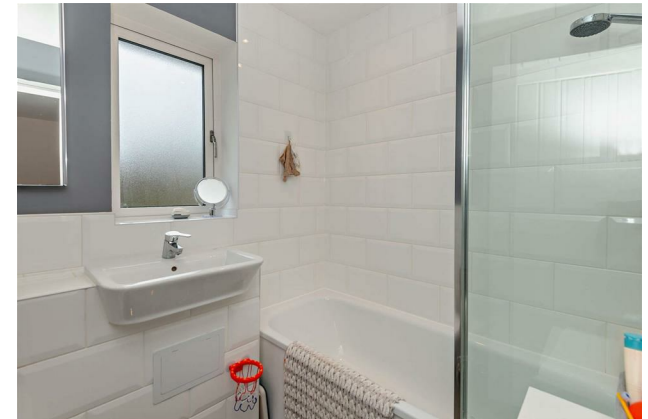

Features

- Popular Location
- Contemporary style
- Modern Kitchen leading to Dining Area overlooking garden
- Three Bedrooms
- Built by Taylor Wimpy approx 10 years ago
- Spacious Living area
- En-suite to Master Bedroom
- Two Parking spaces

Aspen Estate Agents incorporating Waterfords

32 High Street

Chobham

Surrey

GU24 8AA

01276 858 589

chobham@waterfords.co.uk



Tenure - Freehold Council Tax Band - E

