



138 Feltham Road, Ashford, TW15 1AD

£795,000

138 Feltham Road, Ashford, TW15 1AD

Aspen Residential are delighted to introduce this stunning detached family home to the market. Situated on Feltham Road, Ashford offering easy access to many of the areas popular schools, local amenities and transport links all of which are just a short walk away.

Upstairs there are four double bedrooms, the master bedroom has a balcony over looking the garden. The four bedrooms share the family bathroom which has a modern four piece bathroom suite.

Downstairs this property has flexible living space and two double bedrooms. The large lounge is at the front of the house leading onto the dining room which has a door into the kitchen and double doors to the garden. The large kitchen has ample storage cupboards, integrated appliances and plenty of worktop space. The family room offers another reception room for casual dining and has bi-folding doors onto the garden. The sunny garden is a good size with a large patio area and lawn area. This property also benefits from several outbuildings which can be used for multiple purposes and there is rear access and off road parking for multiple vehicles.

This property would be perfect for a growing family or a family looking for multi-generational living and should be seen to be fully appreciated. Viewings can be booked by calling Aspen Residential.



Floor Plan

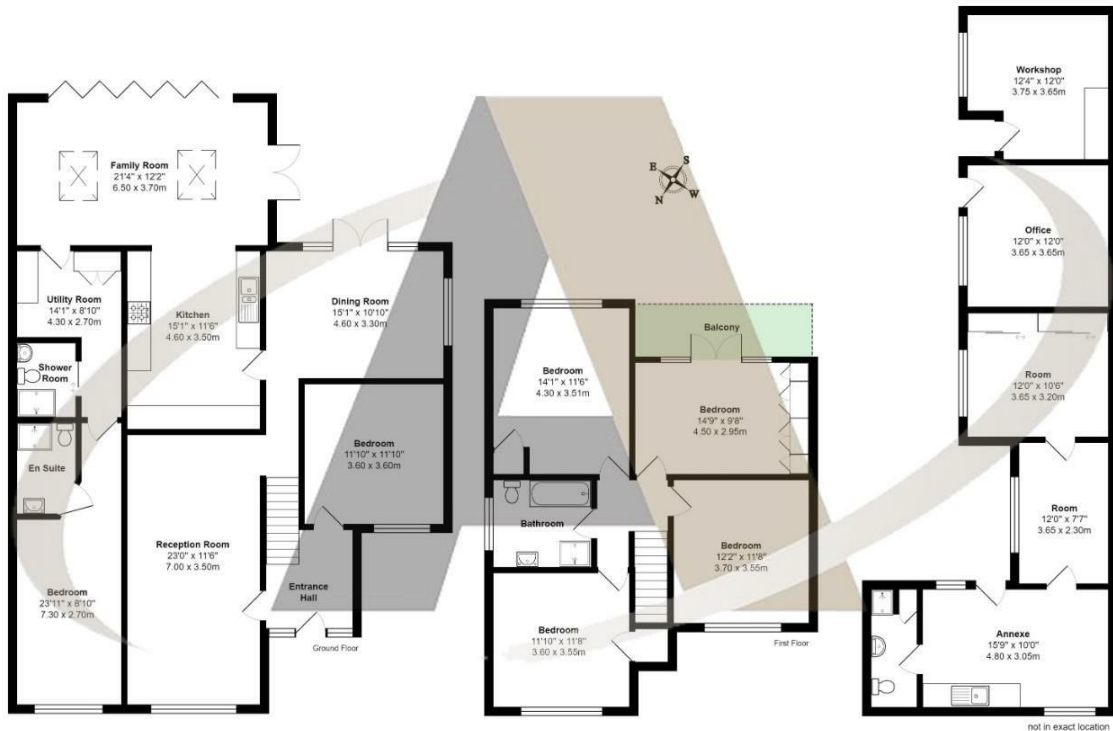

Feltham Road, Ashford

Total Area: 2342 ft² ... 217.6 m² (excluding outbuildings)
 All measurements are approximate and for display purposes only

OUTBUILDINGS
 Approx.
 654 sq.ft
 60.7 sq.m



Features

- Down stairs shower room
- Flexible Living Space
- Balcony on Primary Bedroom
- Large Kitchen / Family Room
- Off Road Parking
- Stunning Detached Family Home
- 6 Double Bedrooms
- Flexible Outbuildings

Aspen Residential Services
 77 Church Road, Ashford, Surrey, TW15 2PE
 Tel: 01784 252 202
 Email: enquiries@aspensalesandlettings.com



