



Flat 5, 77 Feltham Hill Road, Ashford, TW15 2DH

£260,000

Flat 5, 77 Feltham Hill Road, Ashford, TW15 2DH

Aspen Residential are delighted to introduce this larger than average two bedroom apartment to the market. The Elms is a popular development of just 12 apartments situated on Feltham Hill Road, Ashford and just a few moments walk from Ashford Town Centre, Station, popular schools and transport links. Occupying the front of the building on the first floor the well presented accommodation comprises:- large lounge / diner, two double bedrooms, modern kitchen and three piece bathroom. Sold with an allocated parking space and long lease. This property would be a perfect first time buy or investment and prompt viewings are encouraged.



Floor Plan

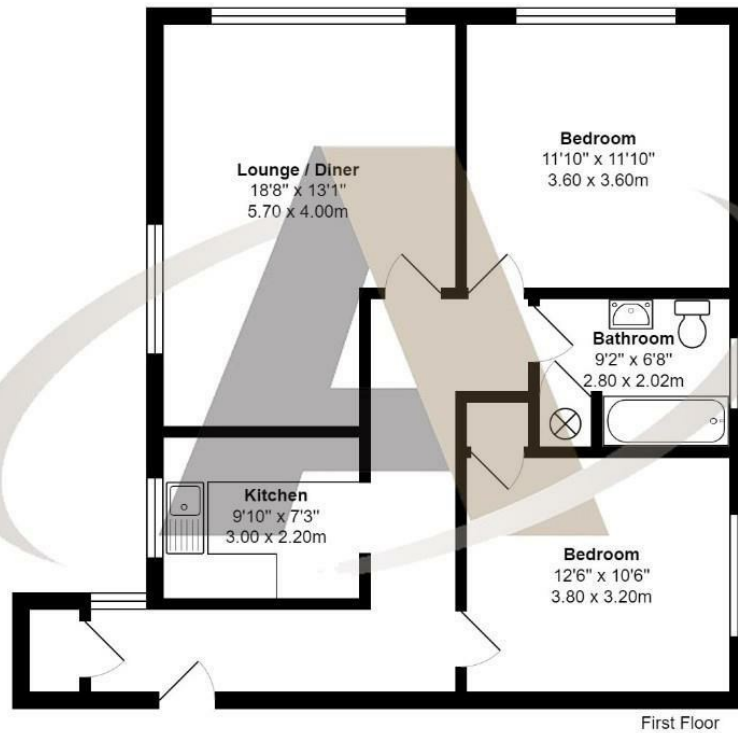

The Elms, Feltham Hill Road, Ashford

Total Area: 786 ft² ... 73.0 m²
All measurements are approximate and for display purposes only



Features

- Allocated Parking
- 2 Double Bedrooms
- Modern Kitchen & Bathroom
- Popular Location for Schools, Amenities and Transport
- Separate Kitchen
- Well Presented Throughout
- Large Lounge / Diner



