



159 Charlton Road, Shepperton, TW17 0RL

£485,000



## 159 Charlton Road, Shepperton, TW17 0RL

Nestled in the heart of Charlton Village on the sought-after Charlton Road, this charming three-bedroom semi-detached home offers the perfect balance of comfort and future potential. The inviting entrance hall leads to a convenient downstairs WC and a spacious open-plan living and dining area, ideal for family gatherings and entertaining. The well-appointed kitchen, along with the dining area, opens directly onto the expansive rear garden, seamlessly blending indoor and outdoor living spaces.

The very well kept garden provides ample space for outdoor enjoyment and features a driveway with rear access and a single garage, ensuring plenty of parking and storage. The attractive front garden enhances the property's curb appeal, overlooking the charming village setting. Upstairs, two sizeable double bedrooms and a cozy single bedroom offer flexible family living, served by a well-equipped family bathroom. With the exciting potential for a double-story extension (subject to planning permission), this delightful home presents a rare opportunity to create a truly bespoke family residence in a desirable location. Call Alex White and his market leading sales team at Aspen Estate Agents.



Floor Plan

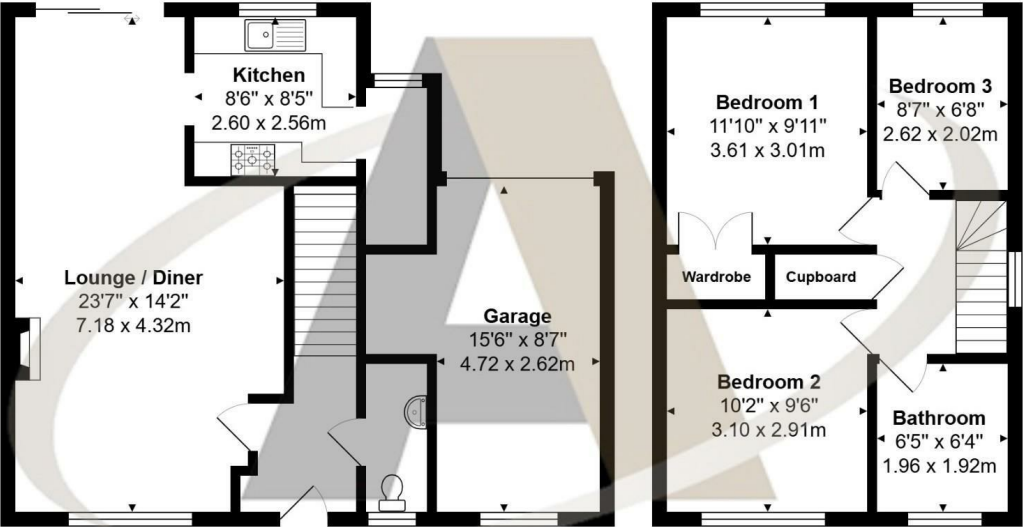

Features

- Situated in the heart of Charlton Village on the highly sought-after Charlton Road.
- Well-appointed kitchen with direct access to the expansive rear garden.
- Large rear garden ideal for outdoor activities, complete with driveway access and a single garage.
- Two spacious double bedrooms and a cozy single bedroom served by a well-equipped family bathroom.
- Open-plan living and dining space, perfect for family gatherings and entertaining.
- Welcoming entrance hall with a downstairs WC for added convenience.
- Attractive front garden enhancing the property's presence in the picturesque village setting.
- Opportunity for a double-story extension (subject to planning permission) to personalize and expand the home.

