



Flat 3 Verden Court Kenilworth Road, Ashford, TW15 3DS

£265,000



## Flat 3 Verden Court Kenilworth Road, Ashford, TW15 3DS

Situated within walking distance of the town center and station, this ground-floor two-bedroom apartment offers a fantastic blend of convenience, comfort, and value. Boasting a long lease of 147 years and a remarkably low service charge of just £25 per month, this property is ideal for first-time buyers, downsizers, or investors. A private garden, allocated parking, and a garage enhance the appeal, providing practicality alongside a sense of independence. The spacious lounge is perfect for relaxation or entertaining, while the master bedroom benefits from double-aspect windows, creating a bright and airy ambiance.

The apartment's thoughtful design ensures every space is functional and inviting. Both bedrooms offer ample room for furniture, while the overall layout maximizes comfort and flow. The private garden provides an outdoor retreat, perfect for enjoying warm days or cultivating greenery, and the proximity to the town center and station ensures effortless access to local amenities and excellent transport links. With its impressive features and unbeatable location, this property presents a unique opportunity to enjoy the best of apartment living. Call Alex White and his market leading sales at Aspen Estate Agents.



Floor Plan

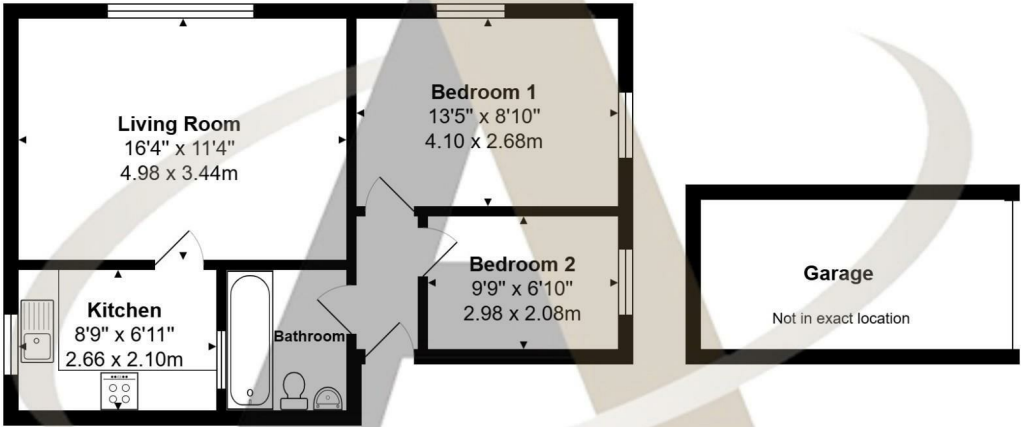

Features

- Ground-floor two-bedroom apartment within walking distance of the town center and station.
- Long lease of 147 years, providing peace of mind and long-term value.
- Low service charge of just £25 per month, making it a cost-effective choice.
- Includes a private garden, perfect for outdoor relaxation and entertaining.
- Features allocated parking and a garage for added convenience and storage.
- Spacious lounge ideal for relaxation or hosting guests.
- Master bedroom with double-aspect windows, creating a bright and airy atmosphere.
- Thoughtfully designed layout with functional and inviting living spaces.



Tenure - Leasehold    Council Tax Band - C



