



35 Park Road, Ashford, TW15 1EX

£500,000

35 Park Road, Ashford, TW15 1EX

This deceptively spacious three double-bedroom semi-detached family home offers exceptional living space and is perfectly located within easy reach of Ashford's most sought-after schools, the vibrant town centre, and beautiful local parks. Extensively extended, the property boasts versatile accommodation featuring two generously sized reception rooms, a convenient downstairs W.C., and a large integral garage. The good-sized rear garden provides ample outdoor space for relaxation and entertaining, while the private driveway ensures easy parking.

With further potential for extension (subject to planning), this home is ideal for a growing family looking to create their dream space. Sensibly priced for an early sale, the property is offered with NO ONWARD CHAIN, allowing for a hassle-free purchasing process. For viewings and enquiries, contact the vendors' chosen sole agents, Aspens, on 01784 252202.



Floor Plan

35, Park Road, Ashford, TW15 1EX

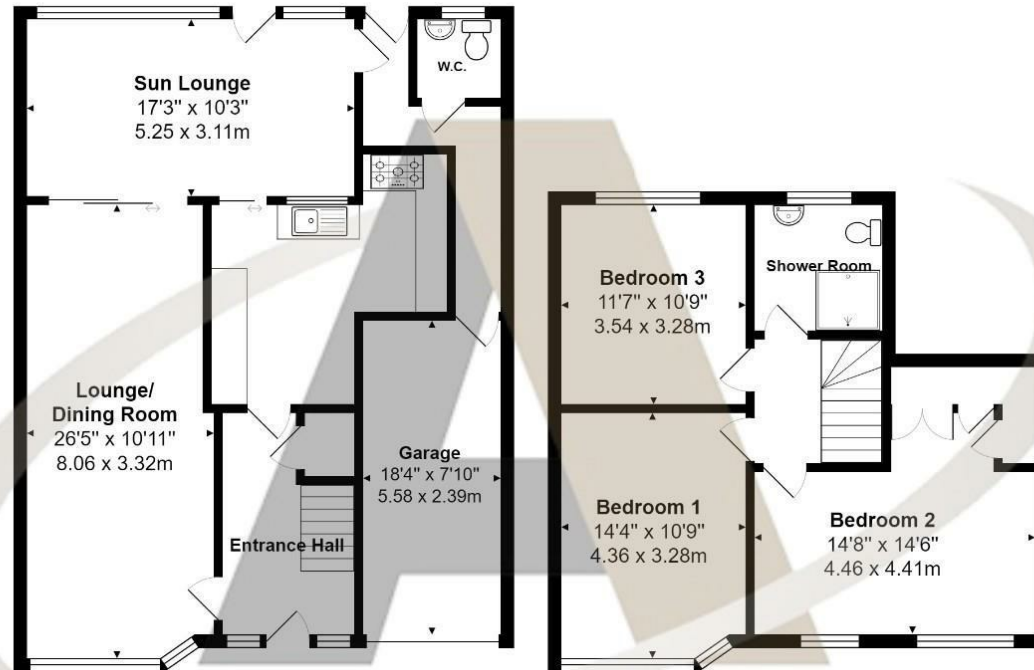

Total Area: 1624 ft² ... 150.8 m²

All measurements are approximate and for display purposes only



Features

- Three double bedrooms offering spacious accommodation throughout.
- Downstairs W.C. providing added convenience for guests and daily use.
- Generously sized rear garden ideal for outdoor relaxation and family activities.
- Potential for further extension (subject to planning permission) for added space.
- Two large reception rooms for versatile family living and entertaining.
- Large integral garage with potential for conversion or extra storage space.
- Private driveway offering secure and convenient off-street parking.
- No onward chain ensuring a smooth and quick purchasing process.

Aspen Residential Services
77 Church Road, Ashford, Surrey, TW15 2PE
Tel: 01784 252 202
Email: enquiries@aspensalesandlettings.com

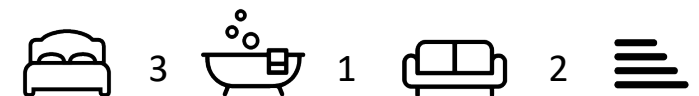

Tenure - Freehold Council Tax Band - E

