



9 Tawny Close, Feltham, TW13 7LH

£1,000 Per Month

9 Tawny Close, Feltham, TW13 7LH

A ground-floor apartment situated in a quiet, yet convenient location close to Feltham Town Centre. The apartment offers; an entrance hall with storage, a lounge leading to a fitted kitchen with appliances, a double bedroom with built-in wardrobes, and a modern bathroom with an electric shower. The property boasts; gas central heating, double glazing, and a secure video entry phone with the added benefit of allocated parking in the adjacent communal car park. The apartment is surrounded by well-tended communal gardens. AVAILABLE MARCH 23 on a FURNISHED BASIS.



Floor Plan

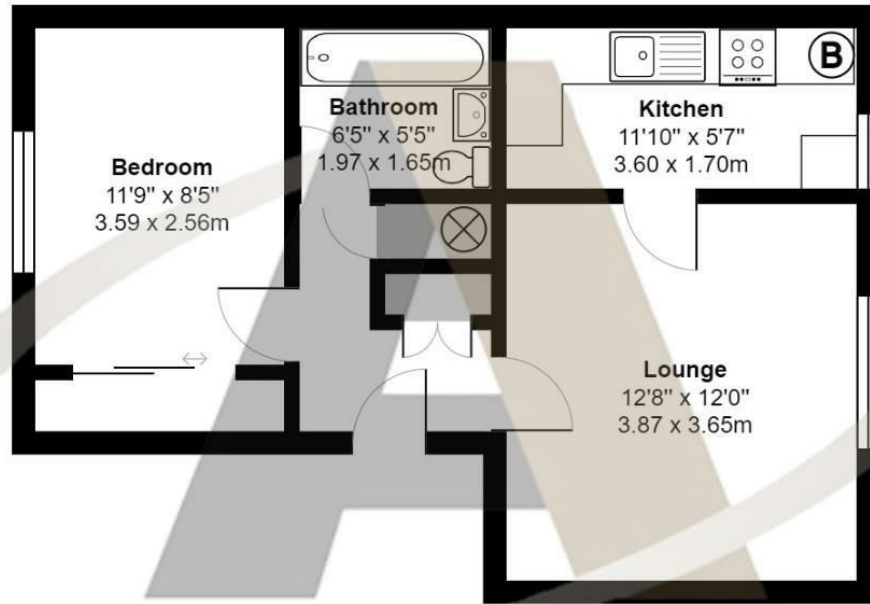

Tawny Close, Feltham

Total Area: 436 ft² ... 40.5 m²

All measurements are approximate and for display purposes only



Features

- Allocated Parking
- Fitted Kitchen
- FURNISHED
- Secure Entry
- Purpose Built Apartment
- AVAILABLE NOW
- Double Bedroom
- Ground Floor
- Bathroom
- Built-in Wardrobes

