



Fairacre, Feltham Hill Road
Ashford TW15 2DU
£225,000

Fairacre, Feltham Hill Road, Ashford, TW15 2DU

Fairacre is an attractive development of just 7 apartments built to a high specification circa 10 years ago. Situated on Feltham Hill Road, Ashford this one-bedroom apartment is conveniently located for Ashford town centre, Station and other local amenities all of which are just a short walk away. Situated on the 1st floor this wonderful property comprises a large reception room with an open plan kitchen, a good size bathroom with a 3 piece luxury bathroom suite, and a double bedroom. This property is offered to the market with an allocated parking space, a long lease, and no onward chain. A perfect first-time buy or investment prompt viewings are encouraged and can be booked by calling Aspen Residential.



Floor Plan

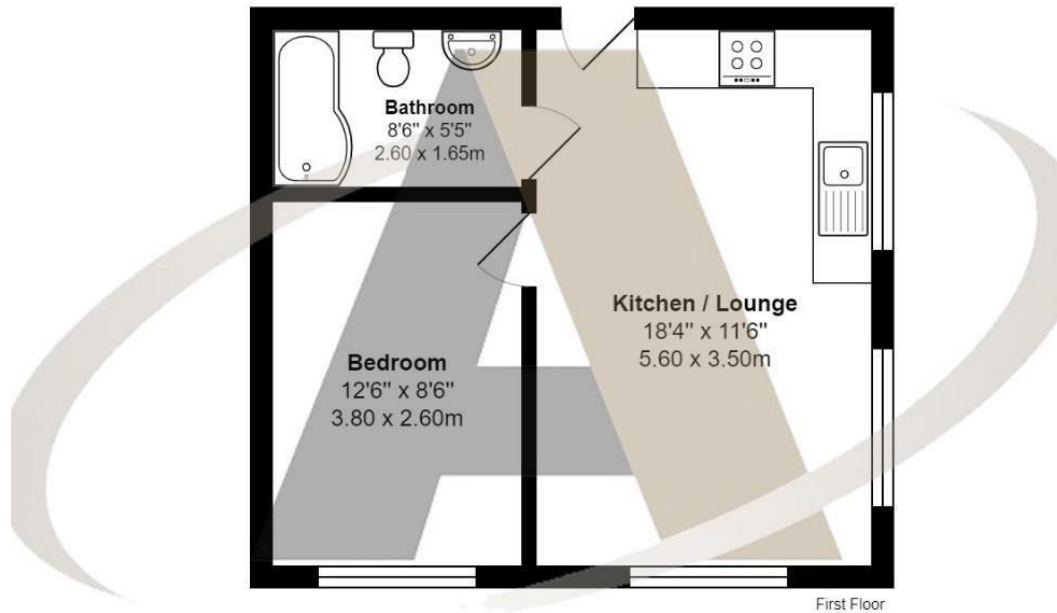

Fairacre, Feltham Hill Road, Ashford

Total Area: 377 ft² ... 35.1 m²

All measurements are approximate and for display purposes only

Area Map



Features

- No Onward Chain
- Modern Development
- Luxury Bathroom
- Long Lease
- Perfect First Time Buy or Investment
- Well Appointed Kitchen
- Close to Town and Station
- Allocated Parking



