





## 176 Whitley Close, Staines-upon-Thames, TW19 7EY

Whitley Close is a popular development of purpose built apartments offering easy access to Heathrow Airport. This larger than average one bedroom apartment is situated on the first floor and consists of a large lounge, bathroom, kitchen, large double bedroom and lots of storage cupboards. This property is sold with a long lease and would be a perfect first time buy or buy to let investment. Call Aspen Residential to arrange your viewing.



## Floor Plan

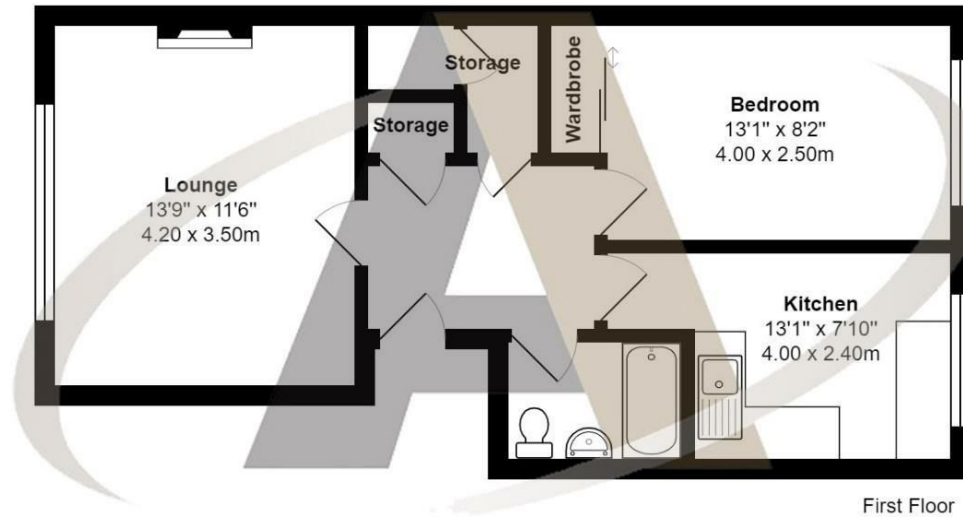

### Whitley Close, Stanwell

Total Area: 508 ft² ... 47.2 m²

All measurements are approximate and for display purposes only



### Features

- One Bedroom
- Ample Storage
- Large Lounge
- Larger than Average Apartment
- First Floor
- Long Lease
- Cul De Sac Location
- First Floor, One Bedroom



