



8 Pippins Court, Ashford, TW15 2AF

£1,100 Per Month



## 8 Pippins Court, Ashford, TW15 2AF

Located in a quiet, yet convenient, cul-de-sac is this beautifully presented starter, offered for rent in immaculate condition. On the ground floor the property offers; an entrance porch, an open plan lounge with an adjacent dining area, and a modern kitchen with appliances. The first floor is reached via a spiral staircase, leading to a double bedroom with built-in wardrobes and a modern bathroom. Benefits from a front garden, double glazing and residents' parking. AVAILABLE mid-January on a unfurnished basis.



## Floor Plan

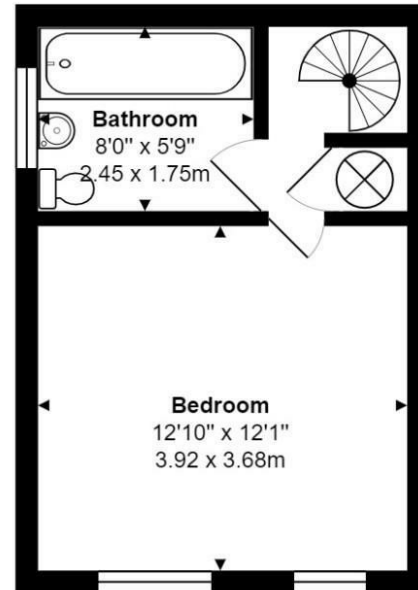
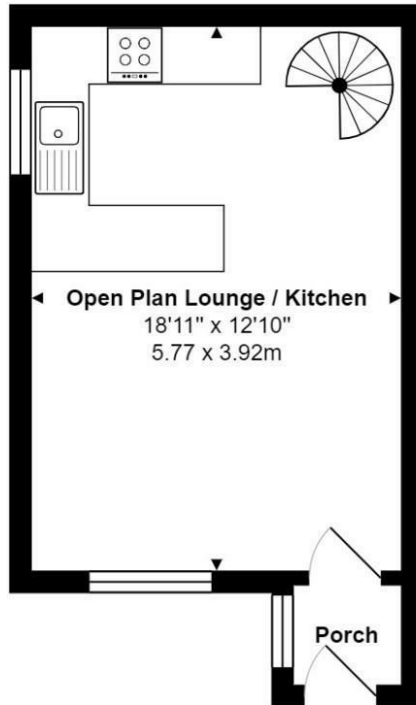

### Features

- Unfurnished
- Bathroom
- Modern Kitchen with Appliances
- Starter Home
- Front Garde
- Double Bedroom
- Built in Wardrobes
- Open Plan Lounge/Kitchen
- Front Garden
- Residents Parking



