



Flat 5, The Elms Feltham Hill Road, Ashford, TW15 2DH

£1,250 Per Month

Flat 5, The Elms Feltham Hill Road, Ashford, TW15 2DH

Aspen Estate Agents are delighted to introduce this lovely two-bedroom apartment to the rental market. Situated on Feltham Hill Road, Ashford this property is within easy walking distance of Ashford town centre, station and many of the areas other transport links and popular schools. The Elms is a development of purpose-built apartments and this property is on the first floor. Accommodation comprises of two double bedrooms, a large lounge diner, a modern kitchen and a three-piece bathroom. This property has an allocated parking space and would suit a professional couple. Prompt viewings are encouraged. Available Now.



Floor Plan

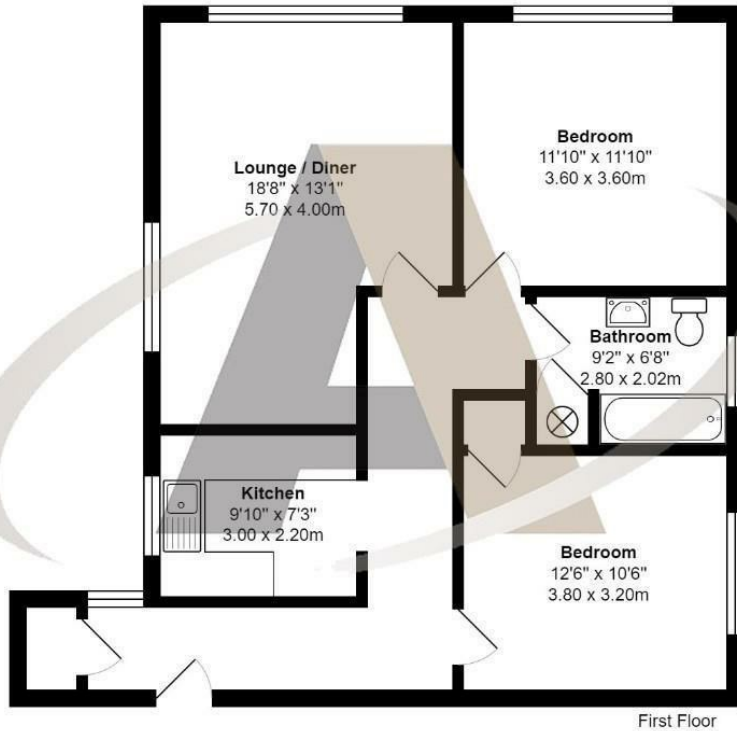

The Elms, Feltham Hill Road, Ashford

Total Area: 786 ft² ... 73.0 m²
All measurements are approximate and for display purposes only



Features

- 2 Double Bedrooms
- Large Lounge / Diner
- Allocated Parking
- Available Now
- Modern Kitchen
- 1st Floor Apartment
- Close to town and Station

Aspen Residential Services
77 Church Road, Ashford, Surrey, TW15 2PE
Tel: 01784 252 202
Email: enquiries@aspensalesandlettings.com



Tenure - Council Tax Band -

