



10 Fairview Court Manor Road, Ashford, TW15 2SN

Nestled on one of Ashford's most prestigious roads and fronting the picturesque Ashford Manor Golf Course, this stunning and rarely available ground-floor apartment offers an exceptional blend of space, light, and exclusivity. Set within beautifully maintained communal grounds, the property occupies the most desirable position within this sought-after development, benefiting from windows on all sides that flood the home with natural light. As the larger of the two available layouts, the apartment boasts an impressive footprint of over 920 sq. ft., providing generously proportioned and well-designed living accommodation throughout.

The property features two spacious double bedrooms, including a beautifully presented main bedroom with modern fitted wardrobes, as well as two well-appointed bathrooms for added convenience. Additional highlights include a private garage located in a nearby block, a share of the freehold, and an outstanding lease term of more than 940 years with no ground rent. Offered to the market with no onward chain, this exceptional home represents a rare opportunity to secure a premium apartment in one of Ashford's most exclusive settings. Call Alex White and his market leading sales team at Aspen estate agents.



Floor Plan

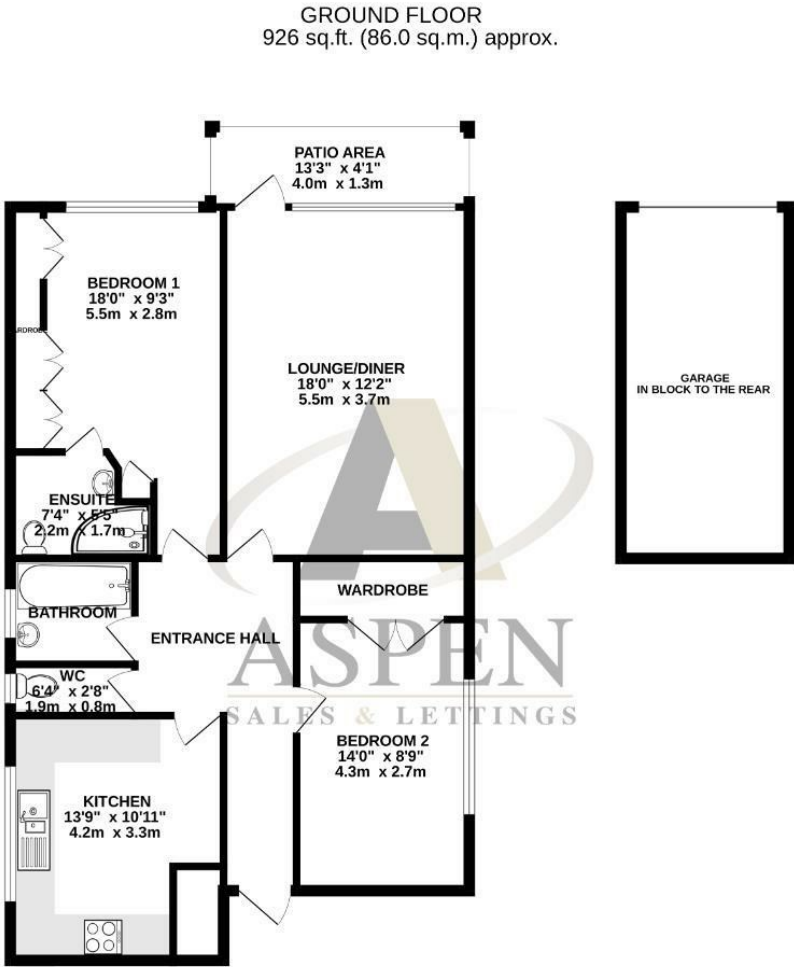

TOTAL FLOOR AREA: 926 sq. ft. (86.0 sq.m.) approx.
Whilst every attempt has been made to ensure the accuracy of the floorplan contained here, measurements of doors, windows, rooms and any other items are approximate and no responsibility is taken for any error, omission or mis-statement. This plan is for illustrative purposes only and should be used as such by any prospective purchaser. The services, systems and appliances shown have not been tested and no guarantee is given as to their operability or efficiency can be given.
Made with Metropix 6/2025



Features

- Located on one of Ashford's most prestigious roads
- Situated on the ground floor in an exclusive, sought-after development
- Larger of the two apartment layouts, offering over 920 sq. ft. of accommodation
- Two well-appointed bathrooms for added convenience
- Private garage located in a nearby block
- Fronting the scenic Ashford Manor Golf Course
- Prime position within the block with windows on all sides for exceptional natural light
- Two spacious double bedrooms, including a main bedroom with modern fitted wardrobes
- Beautifully maintained communal grounds
- Share of freehold, 940+ year lease, no ground rent, and sold with no onward chain

Aspen Residential Services
77 Church Road, Ashford, Surrey, TW15 2PE
Tel: 01784 252 202
Email: enquiries@aspensalesandlettings.com

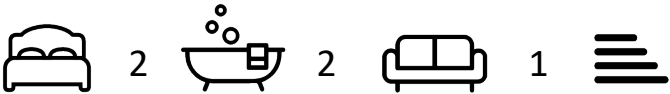

Tenure - Leasehold Council Tax Band - D

