



8 The Doultons Octavia Way, Staines-Upon-Thames, TW18 2QX

Situated in a quiet cul-de-sac just close to Staines Town Centre, this delightful over-55s retirement property offers a comfortable and convenient lifestyle. The home features two well-proportioned bedrooms, a spacious living through dining room, and the current owners have recently refitted the kitchen and bathroom suites to a modern and high specification finish.

Residents can enjoy beautifully maintained communal gardens, comfortable residents' lounges, and convenient on-site parking. Combining tranquillity with easy access to local shops, transport links, and amenities, this property provides the perfect blend of independence and community living. Call Alex White and his experienced and market leading team now to arrange your viewing.



Floor Plan

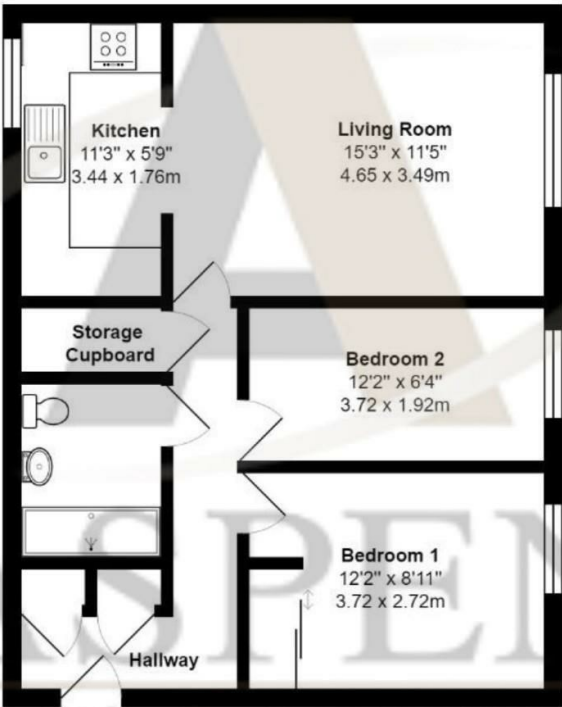

The Doultons, Octavia Way,
Staines-Upon-Thames, TW18 2QX

Total Area: 597 ft² ... 55.4 m²
All measurements are approximate and for display purposes only



Features

Aspen Residential Services
77 Church Road, Ashford, Surrey, TW15 2PE
Tel: 01784 252 202
Email: enquiries@aspensalesandlettings.com



Tenure - Leasehold Council Tax Band - C

