



7 Douglas Road, Addlestone, KT15 2DZ

£1,400 Per Calendar Month

## 7 Douglas Road, Addlestone, KT15 2DZ

Aspen Estate Agents are delighted to introduce this lovely 2 bedroom, split-level maisonette to the lettings market. Situated just a few moment's walk from the recently developed shops, cinema, and restaurants in the Addlesone One complex and Addlestone Station, many local schools and transport links this property would suit a professional couple or small family. The accommodation comprises 2 double bedrooms, the master has built-in wardrobes and overlooks Victory Park, a recently modernised family bathroom, a large lounge with a conservatory perfect as a dining area, and a separate kitchen with ample storage, worktop space, and room for appliances. Outside this property has its own garden perfect for entertaining. This property is available Mid-June on an unfurnished basis. This property is likely to attract a lot of attention and prompt viewings are encouraged and can be booked by calling Aspen Estate Agents.



# Floor Plan

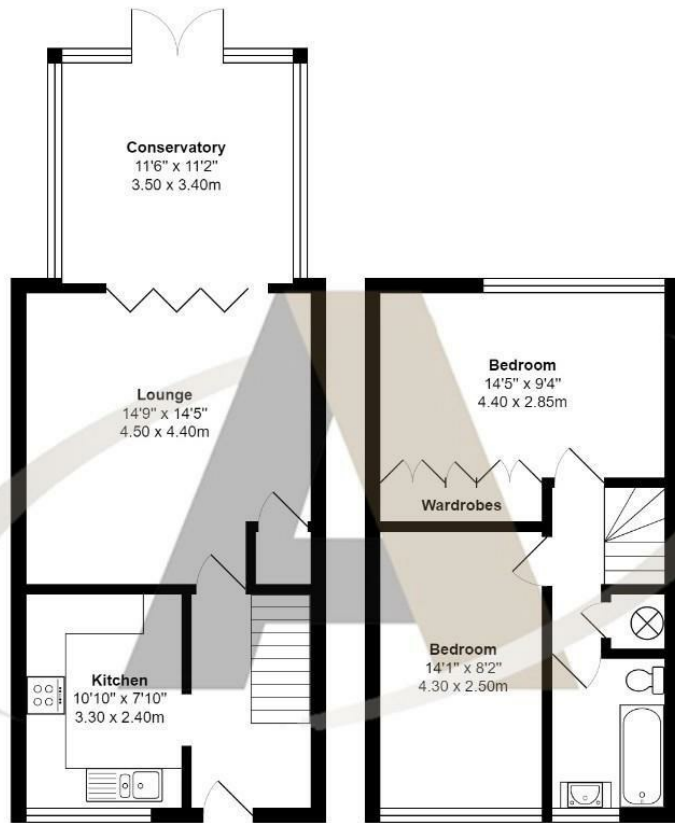

Douglas Road, Addlestone

Total Area: 890 ft<sup>2</sup> ... 82.7 m<sup>2</sup>  
 All measurements are approximate and for display purposes only



## Features

- 2 Bedroom, Split Level Maisonette
- Conservatory
- Close to Addlestone Shops, Cinema, Restaurants and Station
- Overlooking Victory Park
- Large Lounge
- Private Garden
- Convenient for Schools and Transport

Aspen Residential Services  
 77 Church Road, Ashford, Surrey, TW15 2PE  
 Tel: 01784 252 202  
 Email: enquiries@aspensalesandlettings.com



