



35 Maple Gardens, Staines-Upon-Thames, TW19 7BL

This well presented three bedroom terraced home has is situated in a cul-de-sac location. Accommodation comprises of lounge, re-fitted kitchen/diner and three bedrooms. Other notable features include double glazing, allocated parking, re-fitted bathroom, gas central heating and an enclosed private rear garden. The property also benefits from superb road links to the M25, M4 and M3. It also offers easy access to Heathrow Airport. NO ONWARD CHAIN



Floor Plan

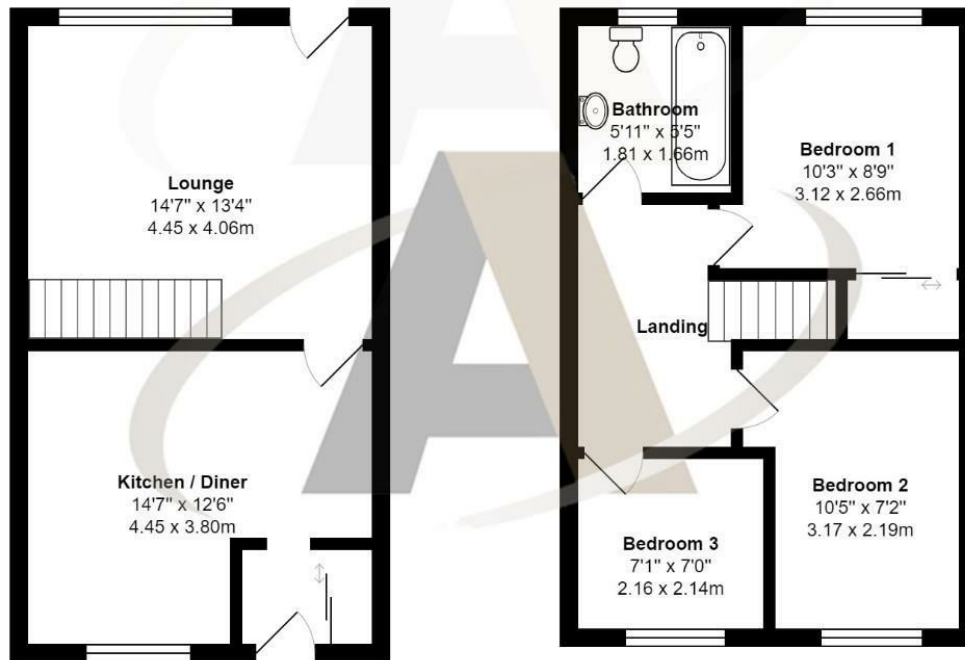

Maple Gardens, Stanwell, TW19 7BL

Total Area: 801 ft² ... 74.4 m² (excluding garden)

All measurements are approximate and for display purposes only



Features

- Three Bedrooms
- Allocated Parking
- Living Room
- Re-Fitted Bathroom
- Kitchen/Diner
- Cul-De-Sac Location
- Private Enclosed Rear Garden
- No Onward Chain

