



Mayfield, 19-21 Stanwell Road, Ashford, TW15 3EY

£1,100 Per Month

Mayfield, 19-21 Stanwell Road, Ashford, TW15 3EY

Offered with the benefit of a private garden, this apartment has one double bedroom, modern bathroom, open plan kitchen, lounge leading directly to the private garden, the apartment also benefits from allocated parking for one car. Ideally located within walking distance of Ashford High Street and Ashford Train Station, offered furnished or unfurnished. Please call for further details and to arrange a viewing.



Floor Plan

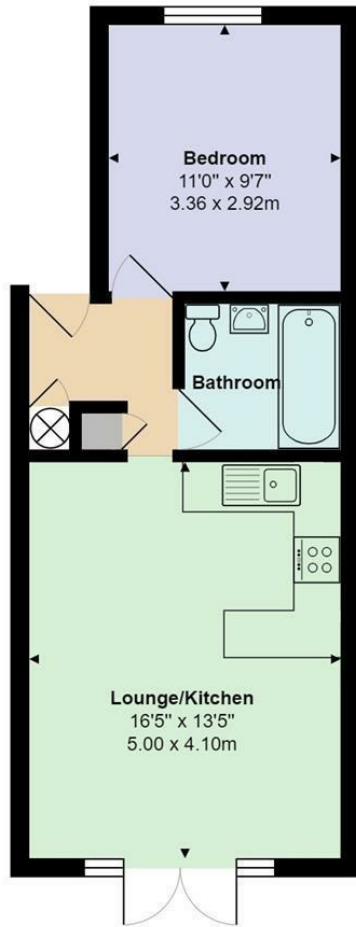

Features

- One Bedroom
- Available Now
- Open Plan Kitchen
- Early Viewing Highly Recommended
- Lounge Leading Directly To Private Garden
- Allocated Parking
- Ground Floor Apartment
- Private Garden
- Close To High Street & Train Station
- Close To High Street Garden

