



5 Everest Road, Staines-Upon-Thames, TW19 7EA

£570,000

5 Everest Road, Staines-Upon-Thames, TW19 7EA

Nestled in a highly sought-after location, this immaculately presented three-bedroom extended semi-detached family home offers an exceptional blend of modern comfort and practical living. Just a short stroll from reputable local schools and convenient shops, the property is perfect for families seeking both convenience and style. The home boasts two versatile reception rooms, with the lounge thoughtfully designed as a cozy cinema room, ideal for family movie nights. The impressive extended kitchen features high-specification finishes, providing a contemporary space for cooking and entertaining.

Externally, the property offers excellent amenities with a spacious private driveway equipped with an electric vehicle charging point, leading to a detached garage for additional storage or parking. The beautifully designed bathroom complements the three generously sized bedrooms, ensuring ample space for family living. This turn-key home effortlessly combines modern luxury with everyday practicality, making it an ideal choice for those seeking a stylish and functional family residence in a prime location. Call Alex White and his market leading sales team at Aspen estate agents.



Floor Plan

GROUND FLOOR
654 sq.ft. (60.7 sq.m.) approx.



1ST FLOOR
431 sq.ft. (40.1 sq.m.) approx.

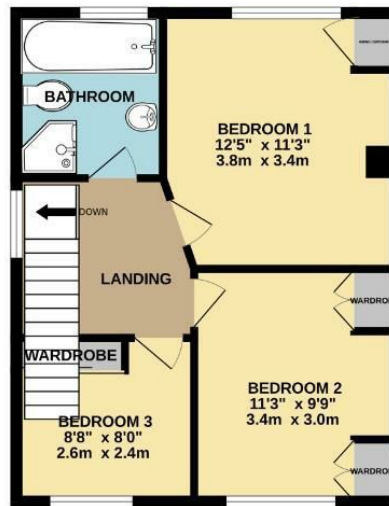

TOTAL FLOOR AREA: 1085 sq.ft. (100.8 sq.m.) approx.

Whilst every attempt has been made to ensure the accuracy of the floorplan contained here, measurements of doors, windows, rooms and any other items are approximate and no responsibility is taken for any error, omission or mis-statement. This plan is for illustrative purposes only and should be used as such by any prospective purchaser. The services, systems and appliances shown have not been tested and no guarantee as to their operability or efficiency can be given.
Made with Metraplan ©2025



Features

- Situated in a highly sought-after area
- Includes a cozy cinema room lounge
- Large own drive featuring an electric vehicle charging point
- High-quality, beautifully designed bathroom
- Generously sized bedrooms offering ample space for family comfort
- Modern kitchen with premium finishes
- Provides additional storage space or secure parking options.
- A perfect blend of contemporary design and practical living

Aspen Residential Services
77 Church Road, Ashford, Surrey, TW15 2PE
Tel: 01784 252 202
Email: enquiries@aspensalesandlettings.com



Tenure - Freehold Council Tax Band - D

