



1 Hooper House, Ashford Crescent, Ashford, TW15 3GN

£225,000

1 Hooper House, Ashford Crescent, Ashford, TW15 3GN

This immaculately presented one-bedroom ground-floor apartment, built by Hooper Homes in 2008, offers contemporary living at its finest. The property features a sleek, fully fitted modern kitchen seamlessly integrated with an open-plan lounge, creating a spacious and inviting living area. The generously sized double bedroom provides ample space and comfort, while the luxury family bathroom adds a touch of elegance. Designed for convenience and efficiency, the apartment also benefits from gas central heating enhanced by a solar thermal water heating system, significantly reducing energy costs.

Located in the sought-after Ashford Crescent, this home enjoys a prime position just a short walk from Ashford Mainline Train Station. It is also within easy reach of local amenities, including Tesco and Lidl superstores, and offers excellent connectivity to the M25, M3, and Heathrow Airport. Additional highlights include an allocated parking space and a secure video-intercom entry system for added peace of mind. With its long lease of 109 years, modern design, strategic location, and energy-saving features, this property is ideal for first-time buyers, professionals, or investors. An internal viewing is highly recommended to truly appreciate all it has to offer. EPC Rating C.



Floor Plan

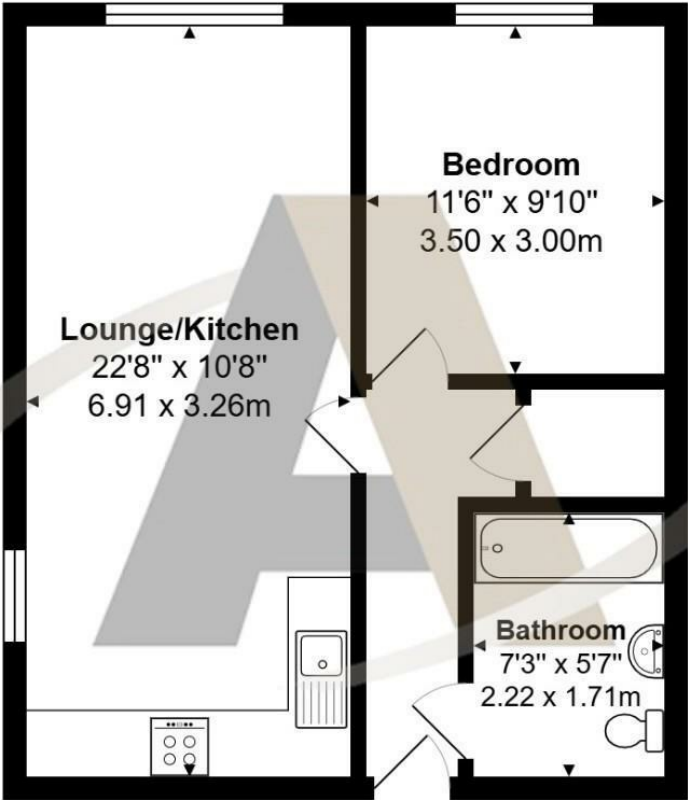

Features

- Ground Floor
- Parking
- Close to Town
- Modern Development
- Good Size Apartment
- Long 109 year lease
- Close to Station
- Sensible Price

