



1 Marquis Court Yeoman Drive
Staines-Upon-Thames TW19
£210,000

1 Marquis Court, Yeoman Drive, Staines-Upon-Thames, TW19 7TH

A fantastic opportunity to purchase a ground floor apartment with its own private terrace. Situated in a popular development in Yeoman Drive which is conveniently located for Heathrow Airport and many of the areas transport links and local amenities in Ashford, Staines and Stanwell. This property is offered to the market in good condition throughout and comprises of a large lounge / diner with doors opening onto the private terrace, a larger than average bedroom with built in wardrobes, separate kitchen with gas hob and a modern bathroom. Other notable features of the property include a long lease, double glazing, gas central heating and an allocated parking space. This property should be seen to be appreciated and viewings can be arranged by calling Aspen Residential.



Floor Plan

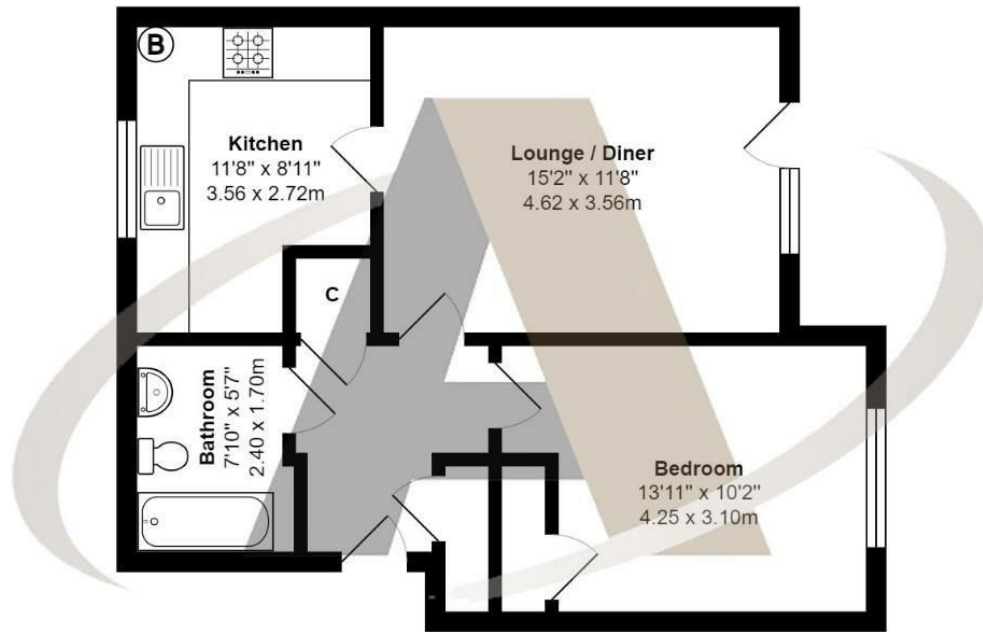

Marquis Court, Yeoman Drive

Total Area: 557 ft² ... 51.7 m²

All measurements are approximate and for display purposes only

Area Map



Features

- Ground Floor Apartment
- Large Lounge / Diner
- Gas Central Heating
- Long Lease
- Private Terrace
- Separate Kitchen
- Allocated Parking

