



GLENCO



2, Glenco Sandells Avenue, Ashford, TW15 1AJ

£1,300 Per Month

2, Glenco Sandells Avenue, Ashford, TW15 1AJ

A truly beautiful first-floor maisonette presented to the market in immaculate condition. Located in a popular road and benefitting from a garage with parking. This spacious property is quietly located at the end of a cul-de-sac and only a short distance from Ashford High Street and transport links. Entrance hall with utility cupboard, washing machine, and stairs to the first floor. Spacious reception room with wooden flooring and TV, open plan luxury kitchen with built-in appliances including oven and dishwasher. Dual aspect master bedroom with wardrobes and a luxury shower room. Externally the property offers a garage with parking in front and a larger than average external storage cupboard. AVAILABLE JULY 2023 on an UNFURNISHED BASIS. Viewings are advised to appreciate the condition of the property.



Floor Plan

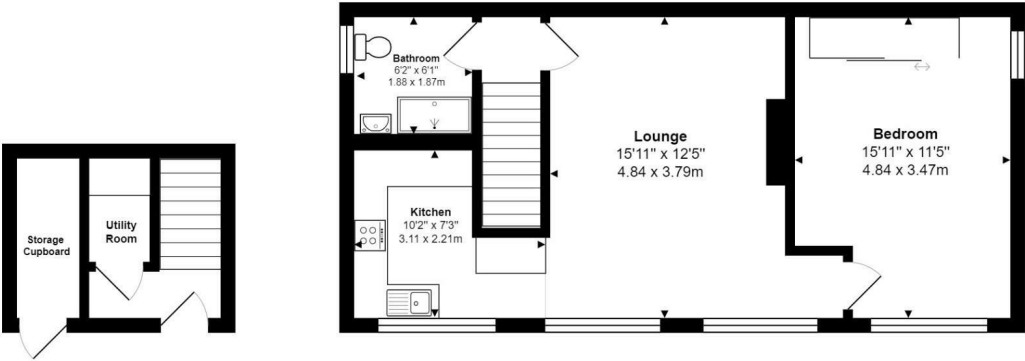

Features

- First Floor Maisonette
- Open Plan Kitchen
- Utility Cupboard
- Gas Central Heating
- UNFURNISHED
- Master Bedroom
- Luxury Shower Room
- Double Glazing
- Garage
- AVAILABLE JULY 2023

