



126 Whitley Close, Staines-Upon-Thames, TW19 7EY

£230,000

126 Whitley Close, Staines-Upon-Thames, TW19 7EY

This one bedroom ground floor maisonette has the added benefit of its own large private rear garden. Accommodation comprises of lounge/diner, large double bedroom with built-in wardrobes and storage cupboard/study area. Other notable features include modern kitchen, gas central heating, double glazing, shower room and private rear garden with rear access. The property has superb links to Heathrow airport, good road links to the M25 and M4.



Floor Plan

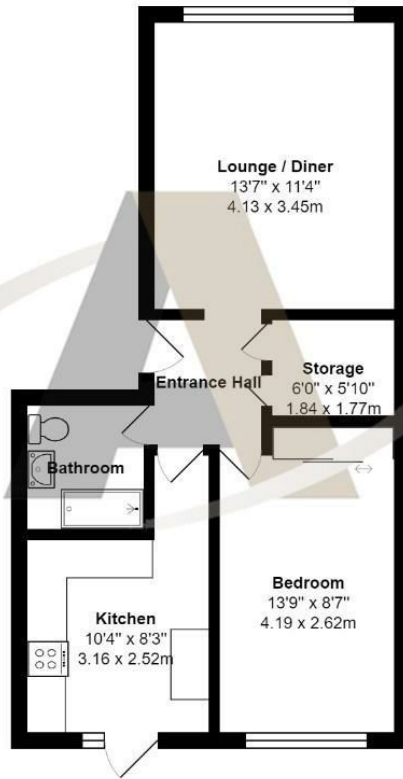

Whitley Close, Stanwell, TW19 7EY

Total Area: 476 ft² ... 44.2 m²

All measurements are approximate and for display purposes only



Features

- Enclosed Private Rear Garden
- Large Double Bedroom
- Lounge/Diner
- Double Glazing
- Ground Floor Maisonette
- Gas Central Heating
- Modern Kitchen

