



11 Berryscroft Court Berryscroft Road, Staines-Upon-Thames, TW18 1NA

This well presented first floor maisonette is situated in a desirable retirement development for the over 60's.

Accommodation comprises of a double bedroom with built-in furniture, living room and dining room. Other notable features include re-fitted bathroom, re-fitted kitchen, upvc double glazed windows, ample storage, communal lounge, communal laundry area, communal parking and well kept communal gardens. The property benefits from being a short distance to local amenities and bus routes.



Floor Plan

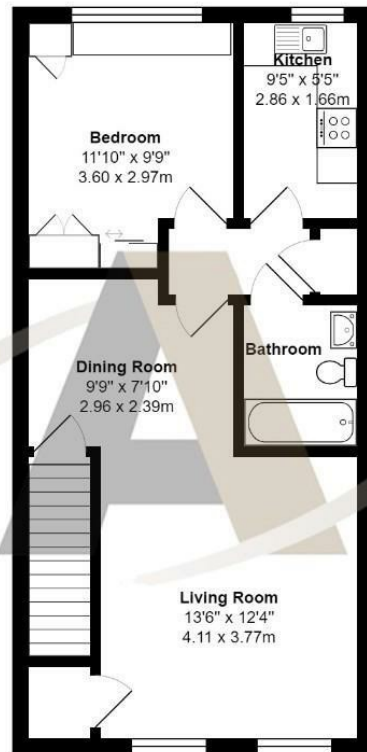

Berryscroft Court, Laleham, TW18 1NA

Total Area: 544 ft² ... 50.5 m²

All measurements are approximate and for display purposes only



Features

- Retirement Development Over 60's
- Living Room
- Dining Room
- Communal Lounge
- One Double Bedroom
- Re-Fitted Kitchen
- Re-Fitted Bathroom
- Well Kept Communal Grounds

