



6 Bramley Close, Staines-upon-Thames, TW18 1PY

£1,250 Per Month

## 6 Bramley Close, Staines-upon-Thames, TW18 1PY

This one double-bedroom starter home is conveniently situated and within close distance of Staines upon Thames station, town centre, and associated amenities. Benefits include; a spacious open-plan living space with a fully fitted kitchen and appliances, a spiral staircase leading to a large double bedroom with built-in wardrobes, and a modern shower room. Available now on an UNFURNISHED basis. This property is not to be missed!



# Floor Plan

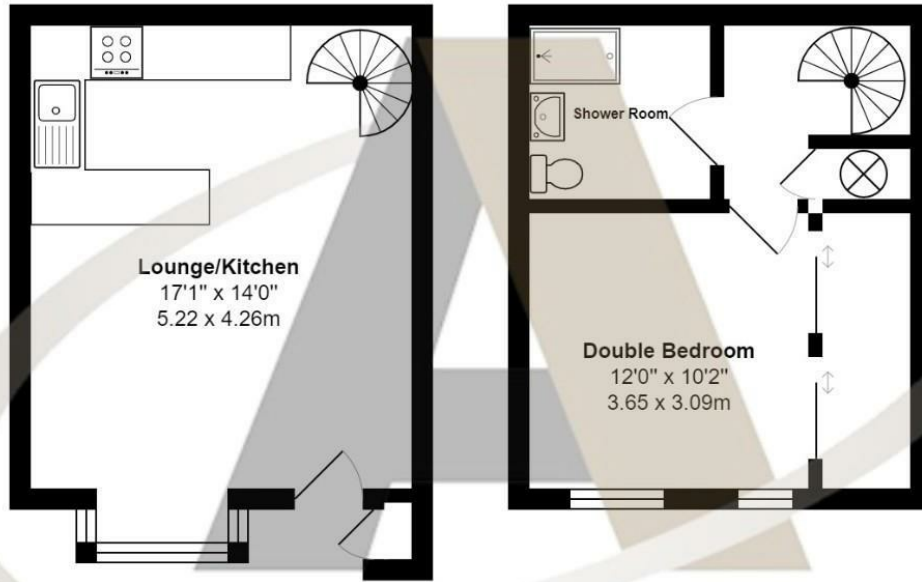

## Bramley Close, Staines upon Thames

Total Area: 487 ft<sup>2</sup> ... 45.3 m<sup>2</sup>

All measurements are approximate and for display purposes only

### Features

- Open Plan Lounge
- Double Bedroom
- Modern Fitted Kitchen with Appliances
- Close to local shops and transport links
- Must See
- UNFURNISHED
- Modern Shower Room
- Built in Wardrobes
- AVAILABLE NOW

