



19 Coniston Way, Egham, TW20 8JW

£415,000

19 Coniston Way, Egham, TW20 8JW

Situated within the ever-popular Bourne Meadow development, this well-presented two double bedroom staggered terraced home enjoys a peaceful position with no passing traffic, offering an ideal setting for first-time buyers, young families or perhaps a 'downsizer'. Built during the late 1980s, the property is conveniently located approximately 1.25 miles from Egham town centre and mainline railway station, with excellent access to local schools, including the renowned TASIS International School.

The accommodation comprises a welcoming entrance hall leading to a spacious lounge/dining room, providing an excellent space for both everyday living and entertaining, particularly with it overlooking and leading onto the rear garden. There is a separate fitted kitchen at the front, whilst upstairs, a landing leads to two double bedrooms and a modern white family bathroom. Further benefits include gas central heating to radiators, double glazed windows throughout, a good-sized enclosed rear garden and residents' parking. Combining a quiet location with well-balanced accommodation and excellent convenience for local amenities and transport links, this is a superb home that must be viewed. EPC Rating: C.



Floor Plan

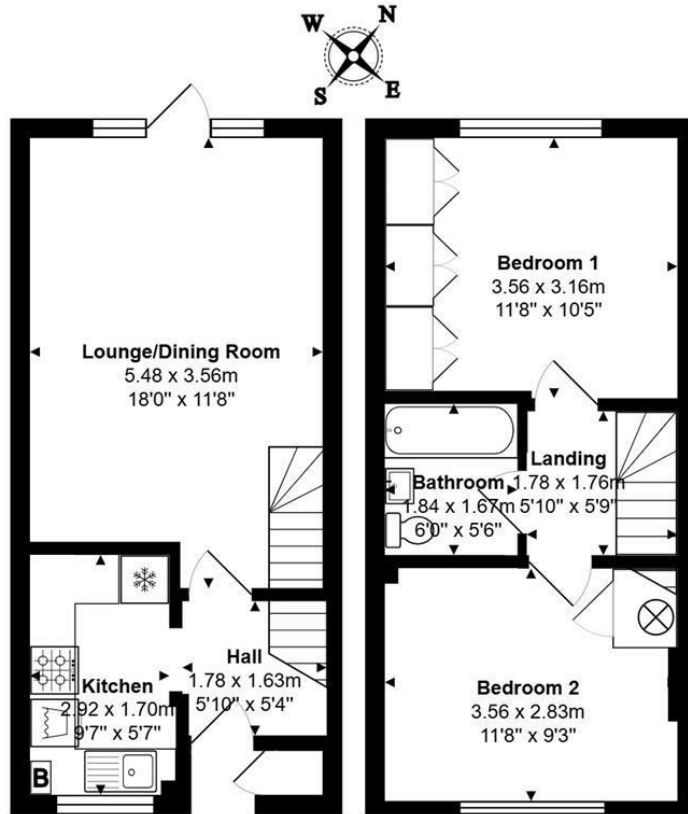

Total Area: 56.4 m² ... 607 ft²



Features

- Two Double Bedroom House
- Lounge/Dining Room
- Modern Upstairs Bathroom
- Gas Central Heating
- Quiet Location
- Good Size Garden
- Separate Kitchen
- Double Glazed
- Residents' Car Parking
- No Onward Chain

10 St Judes Road, Englefield Green, Surrey TW20 0BY
Tel 01784 433696
sales@aspenestateagents.co.uk



Tenure - Freehold Council Tax Band - D

