



9 Elmcroft Drive, Ashford, TW15 2PQ

£1,500 Per Month

9 Elmcroft Drive, Ashford, TW15 2PQ

Situated within a gated development within the heart of the Ashford town centre this ground floor maisonette is available NOW. The maisonette offers spacious accommodation including two double bedrooms, a good size reception room, fitted kitchen with appliances, family bathroom and ample storage. The property has the benefit of a private rear garden and an outside storage shed, further benefits include an allocated parking space, double glazing and gas central heating. Please call for further details and to arrange a viewing.



Floor Plan

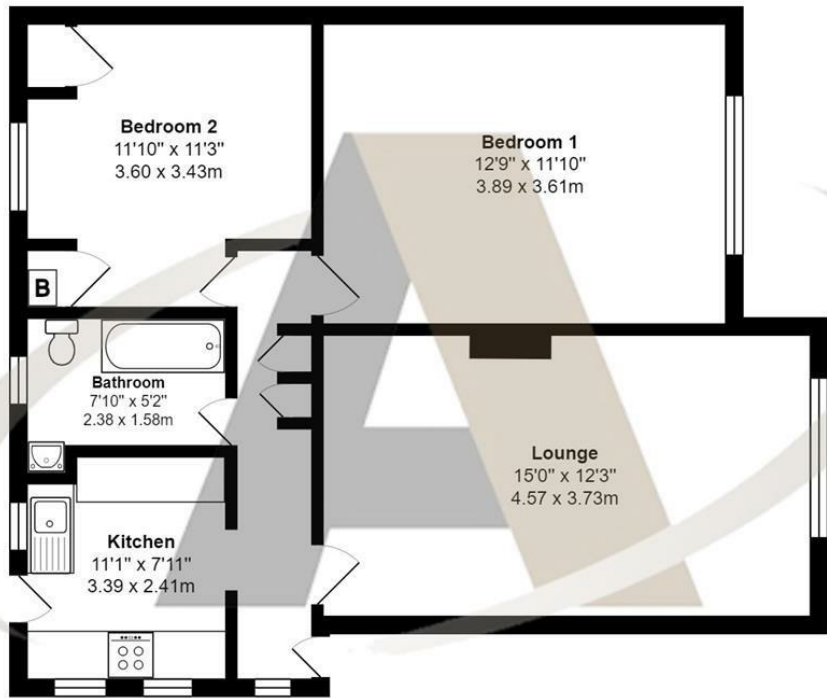

Elmcroft Drive, Ashford

Total Area: 808 ft² ... 75.1 m²

All measurements are approximate and for display purposes only



Features

- Available now
- Unfurnished
- Two double bedrooms
- Viewings Highly Recommended
- Private Garden
- Large lounge
- Central Ashford
- Ground floor maisonette
- Allocated parking
- Gated development

