



Aspen
estate agents



100 Hythe End Road
Staines-Upon-
£550,000

About

This gorgeous looking character building is situated on the banks of the River Thames, formerly owned by the water board and with character in abundance. There are lovely views across the river towards Runnymede and a large south facing patio from which to sit at and enjoy them. The accommodation is well proportioned to include two reception rooms, three double bedrooms and an upstairs bathroom. There is a good size kitchen and a hallway and landing. The property does require some modernisation and will make an ideal project for those seeking to stamp their own personality and style on a property. EPC Rating: G.

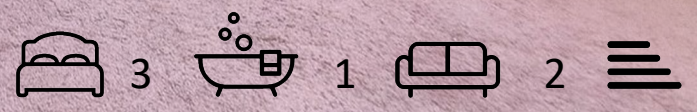

Floor Plan

Hythe End Road Wraysbury, Staines-upon-Thames, Middlesex
 Approximate Gross Internal Area
 Main House = 103 Sq M / 1102 Sq Ft
 Outbuilding = 7 Sq M / 73 Sq Ft

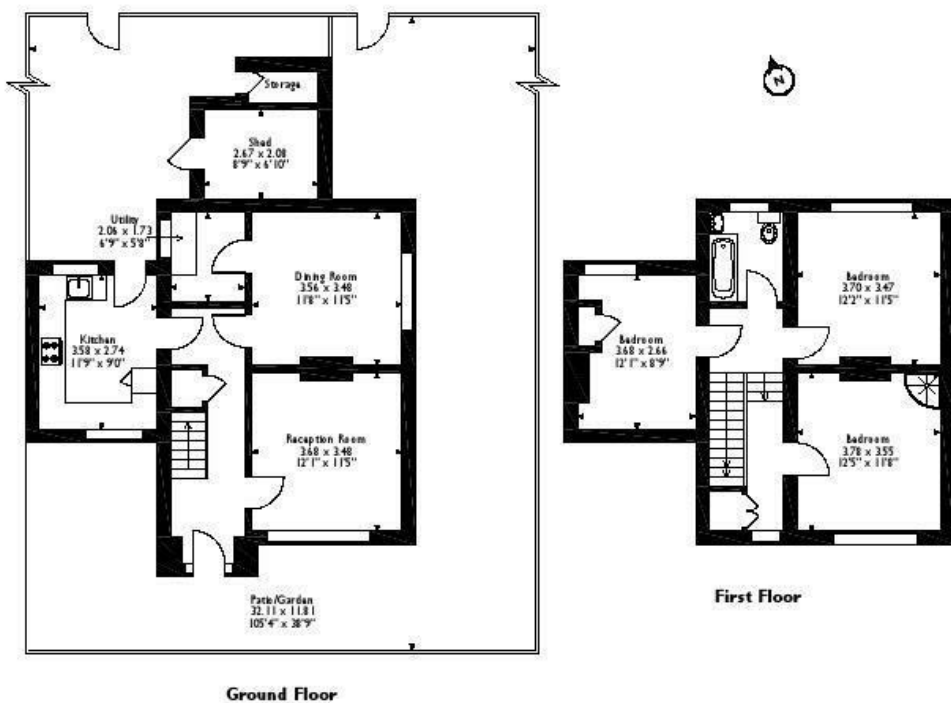

Please note that the location of doors, windows and other items are approximate and this floorplan is to be used for illustrative purposes only. Unauthorized reproduction is prohibited.

Area Map



Energy Efficiency Graph

