



3 Laburnum Place, Egham, TW20 0SX

A four bedroom student property situated in a quiet side road about a 15 minute walk from the university. Three of the bedrooms are good sized double bedrooms and there is a further single bedroom. The bathroom also has a shower enclosure and there are double glazed windows, gas central heating, off road parking and a good size garden. EPC Rating: D.



Floor Plan

Ground Floor

Approx. 39.4 sq. metres (423.9 sq. feet)



First Floor

Approx. 39.8 sq. metres (428.8 sq. feet)

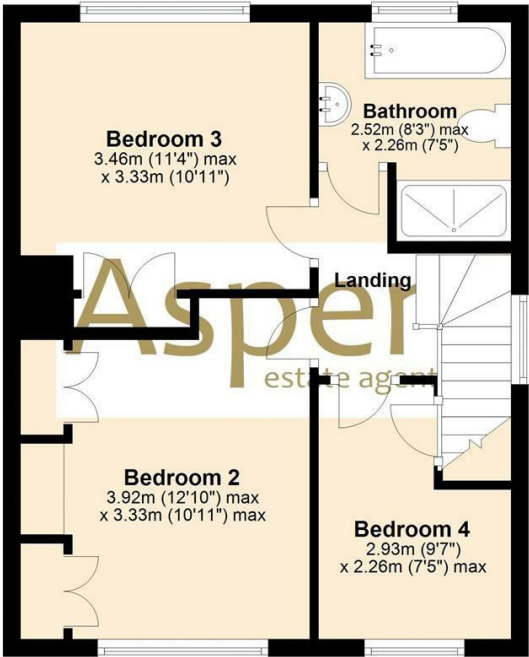

Features

- Four Bedrooms
- Lounge
- Double Glazing
- Off Road Parking
- Fitted Kitchen
- Bathroom with Shower
- Gas Central Heating

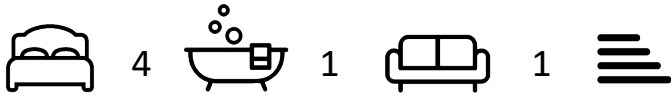

Tenure - Council Tax Band - D

