



25 Hazel Close, Egham, TW20 0TN

This semi-detached house would be suitable for a family or as a buy to let investment, which it has previously been used as. The accommodation is well laid out with 2 good size double bedrooms and 1 large single upstairs along with the shower room. Downstairs is a w.c. kitchen which is part open plan to a living area and two further rooms, which could either be used as single bedrooms or reconfigured back into one large living room. There is gas central heating system to radiators, double glazed windows and a rear garden with brick store shed. EPC Rating: D.



Floor Plan

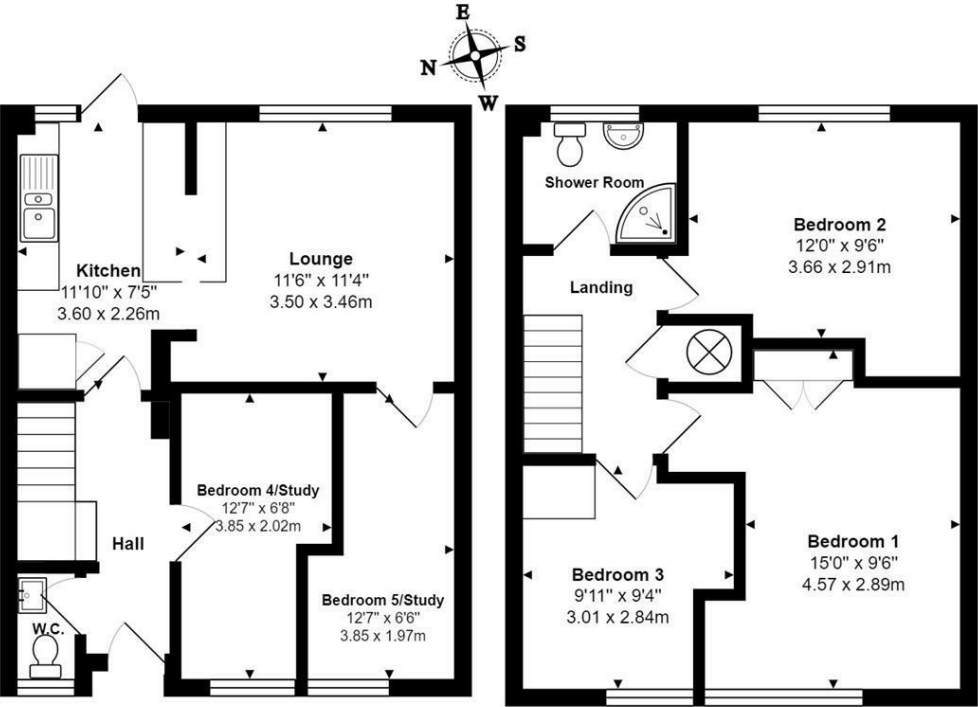

Total Area: 953 ft² ... 88.6 m²



Features

10 St Judes Road, Englefield Green, Surrey TW20 0BY
Tel 01784 433696
sales@aspenestateagents.co.uk

