



4 Caddy Close, Egham, TW20 9JL

£3,250 Per Month



## 4 Caddy Close, Egham, TW20 9JL

This four/five bedroom detached property is located in a popular development in Egham, walking distance to the town centre, Train Station and Royal Holloway University . The property benefits from ample off street parking, a private rear garden, garage storage and 2 bathrooms.



Floor Plan

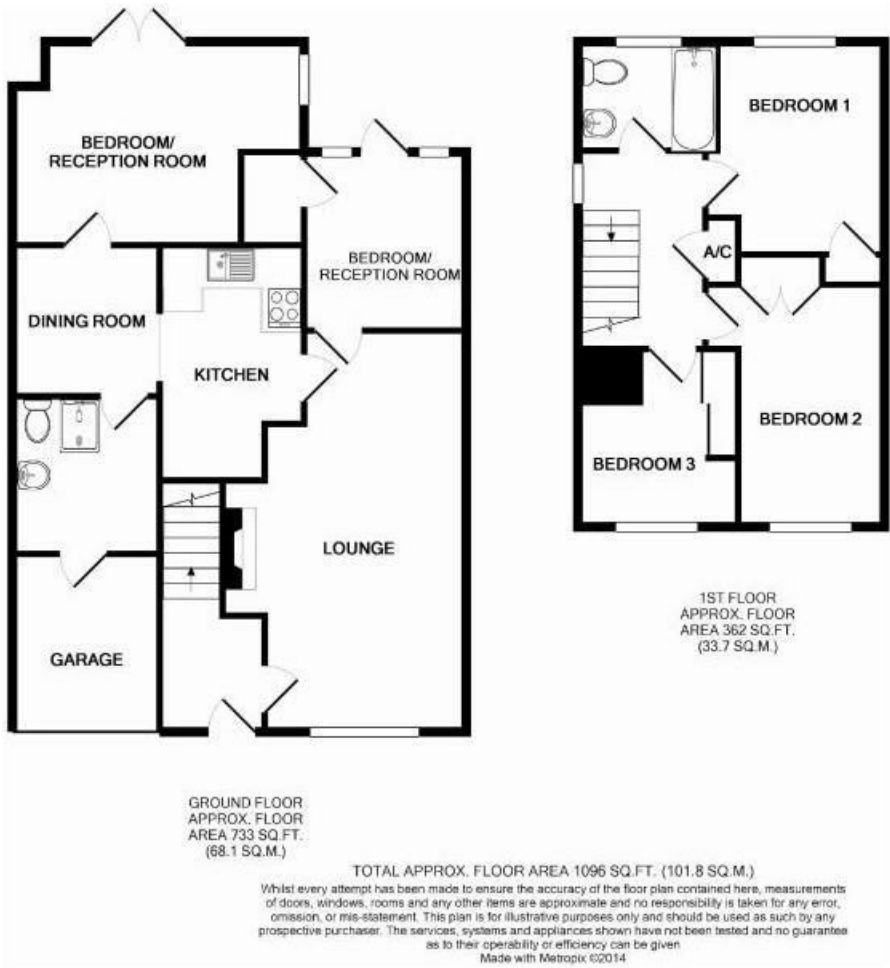

Features

10 St Judes Road, Englefield Green, Surrey TW20 0BY  
Tel 01784 433696  
sales@aspenstateagents.co.uk



5



2



1



D

Tenure - Council Tax Band -



