



LET BY
Aspen
estate agents
www.aspenestateagents.co.uk
01784 433696

25 St Judes Road, Egham, TW20 0BY

£2,500 PCM

25 St Judes Road, Egham, TW20 0BY

A three bedroom student house situated within a few minutes' walk to the university. There are three double bedrooms and two shower rooms, with a kitchen/diner on the lower ground floor, a downstairs cloakroom and a snug on the ground floor. There is also a good size garden. EPC Rating: C.



Floor Plan

Lower Ground Floor
Approx. 31.7 sq. metres (341.6 sq. feet)

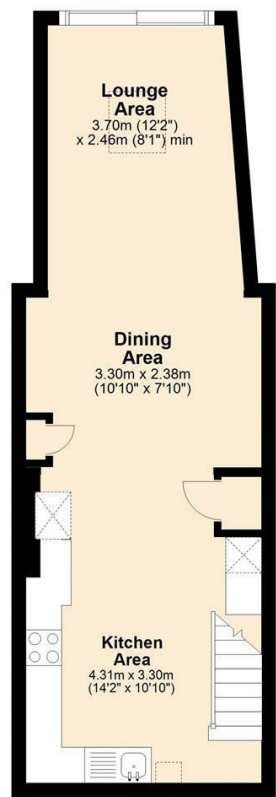

Ground Floor
Approx. 22.7 sq. metres (244.2 sq. feet)

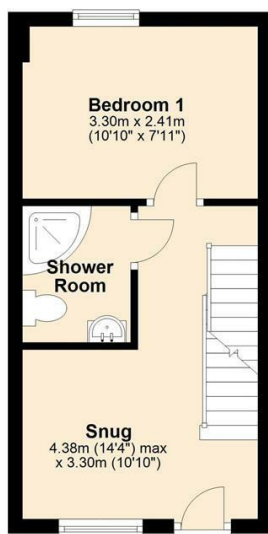

First Floor
Approx. 22.0 sq. metres (236.8 sq. feet)



Features

10 St Judes Road, Englefield Green, Surrey TW20 0BY
Tel 01784 433696
sales@aspenestateagents.co.uk

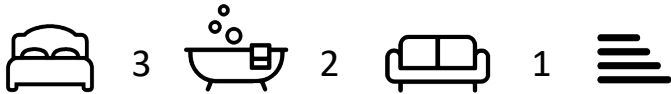

Tenure - Council Tax Band - D

