



2 Mercia House Ashford Road, Ashford, TW15 1PA

£1,700 Per Calendar Month

2 Mercia House Ashford Road, Ashford, TW15 1PA

Available from the Mid October this larger than average ground floor apartment, set in a gated development. The apartment has two double bedrooms with master en-suite, family bathroom, fully fitted kitchen, large lounge diner with direct access to a private patio and gardens and allocated parking. Offered part furnished / unfurnished, please call for further details and to arrange a viewing.



Floor Plan

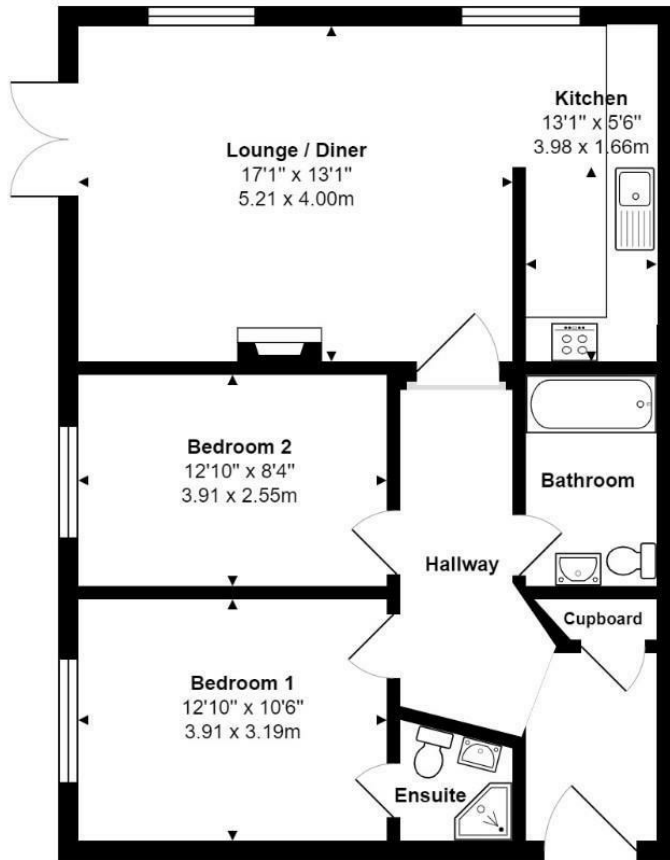

Features

- Ground Floor Apartment
- En-Suite Shower Room
- Fitted Kitchen
- Private Patio
- Part / Unfurnished
- Two Double Bedrooms
- Family Bathroom
- Large Lounge
- Gated Development
- Available Mid October

10 St Judes Road, Englefield Green, Surrey TW20 0BY
 Tel 01784 433696
 sales@aspenestateagents.co.uk

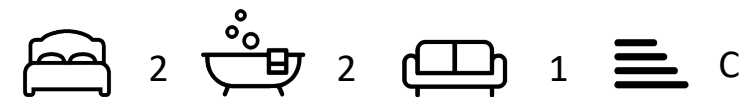

Tenure - Council Tax Band - D

