



Ridgeway Estate Agents Burford Street, Lechlade, Gloucestershire,

£950 Per Calendar Month

- Retail Shop Available for Rent
- Available NOW
- Sought After Position
- View Immediately
- Popular High Street

GROUND FLOOR
468 sq.ft. (43.5 sq.m.) approx.

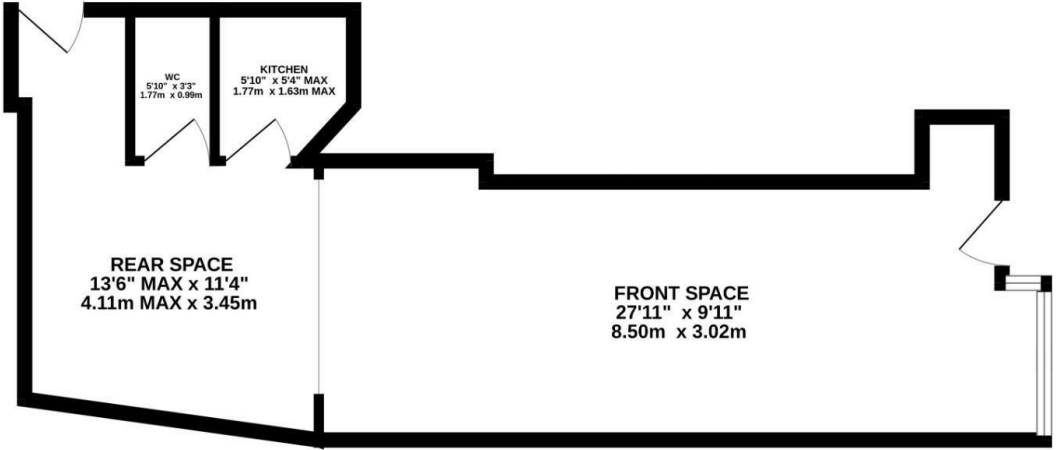

TOTAL FLOOR AREA: 468 sq.ft. (43.5 sq.m.) approx.
Whilst every attempt has been made to ensure the accuracy of the floorplan contained here, measurements of doors, windows, rooms and any other items are approximate and no responsibility is taken for any error, omission or mis-statement. This plan is for illustrative purposes only and should be used as such by any prospective purchaser. The services, systems and appliances shown have not been tested and no guarantee as to their operability or efficiency can be given.
Made with Metropix ©2025



Directions

Viewings

Viewings by arrangement only. Call 01367 250011 to make an appointment.

Council Tax Band

EPC Rating:

Energy Efficiency Rating		Current	Potential
<i>Very energy efficient - lower running costs</i>			
(92 plus) A			
(81-91) B			
(69-80) C			
(55-68) D			
(39-54) E			
(21-38) F			
(1-20) G			
<i>Not energy efficient - higher running costs</i>			
England & Wales		EU Directive 2002/91/EC	