



Whitney Street, Town Centre, SN1 5QH

Asking Price £170,000

- New to the Market
- Two Double Bedrooms
- Rear Driveway Off-Road Parking for One Car
- No Onward Chain
- Spacious Sitting Room
- Ground-Floor Bathroom
- Gas Central Heating
- Kitchen/Diner
- Enclosed Courtyard Garden
- Ideal Investment or First Time Purchase

We are delighted to bring to the market this well-positioned, two-bedroom house in the heart of Swindon town centre. Offered with no onward chain, the property comprises a spacious sitting room, a kitchen/diner, two double bedrooms, and a ground-floor bathroom. Additional benefits include an enclosed courtyard garden and off-road rear driveway parking for one car.

EPC Rating - C

Council Tax Band - B

Heating Type - Gas Central Heating

Freehold





GROUND FLOOR
397 sq.ft. (36.9 sq.m.) approx.

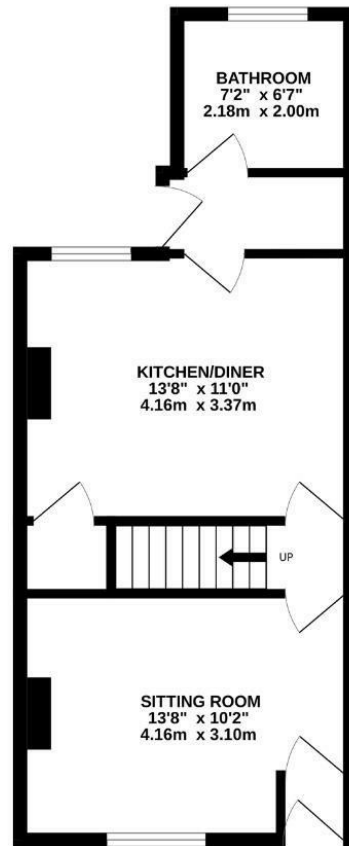

1ST FLOOR
325 sq.ft. (30.1 sq.m.) approx.

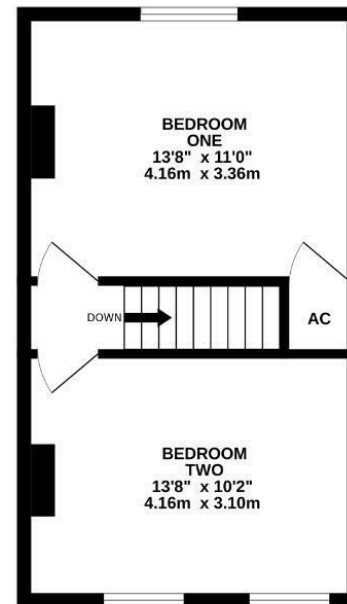

TOTAL FLOOR AREA: 722 sq.ft. (67.1 sq.m.) approx.

Whilst every attempt has been made to ensure the accuracy of the floorplan contained here, measurements of doors, windows, rooms and any other items are approximate and no responsibility is taken for any error, omission or mis-statement. This plan is for illustrative purposes only and should be used as such by any prospective purchaser. The services, systems and appliances shown have not been tested and no guarantee as to their operability or efficiency can be given.
Made with Metropix 62026