



1 Stanborough Close, Borehamwood, Herts WD6 5LU

This spacious four-bedroom end-of-terrace property requires full refurbishment, presenting an excellent opportunity for buyers looking to modernise and add value. The home features great-sized bedrooms, each with fitted wardrobes, offering ample storage space. The property also boasts a large living area with two reception rooms, providing generous space for family living and entertaining.

While in need of updating throughout, this property offers fantastic potential to create your ideal living space. The property further benefits from front and rear gardens, perfect for outdoor activities or future landscaping projects.

Located in a desirable area, the property is just a short walk from local schools, shops, and bus routes, making it an ideal choice for families or commuters.

Reception Room

17'11 x 10'6 (5.46m x 3.20m)

Dinning Room

11'6 x 6 (3.51m x 1.83m)

Kitchen

15'6 x 7 (4.72m x 2.13m)

bedroom 1

13'5 x 10'4 (4.09m x 3.15m)

bedroom 2

13'8 x 8 (4.17m x 2.44m)

bedroom 3

10'3 x 6 (3.12m x 1.83m)

bedroom 4

10'10 x 6 (3.30m x 1.83m)





Ground Floor

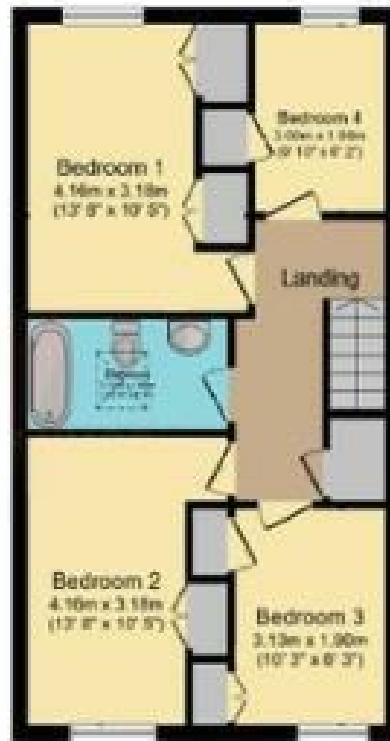

First Floor

Total floor area 104.5 m² (1,124 sq.ft.) approx

This floor plan is for illustrative purposes only. It is not drawn to scale. Any measurements, floor areas (including any total floor area), openings and orientation are approximate. No details are guaranteed, they cannot be relied upon for any purpose and they do not form part of any agreement. No liability is taken for any error, omission or misstatement. A party must rely upon its own inspection(s). Powered by www.localagent.com

