



# Simmons Estates

EST: 1996



## Trinity House, Borehamwood,

**£1,600 PCM**

- Two Double Bedrooms
- Modern Bathroom
- Fitted Wardrobe
- Allocated Parking
- Generous Living Room
- Town Centre
- New Carpet
- Ground Floor Apartment

A well-presented two double bedroom ground floor apartment, ideally located just a short walk from the town centre and railway station. The property benefits from newly fitted carpets throughout, a spacious lounge/diner, a modern bathroom, allocated parking, and excellent access to local amenities and transport links. Offered in good condition throughout, this is an ideal home for professionals and commuters alike.



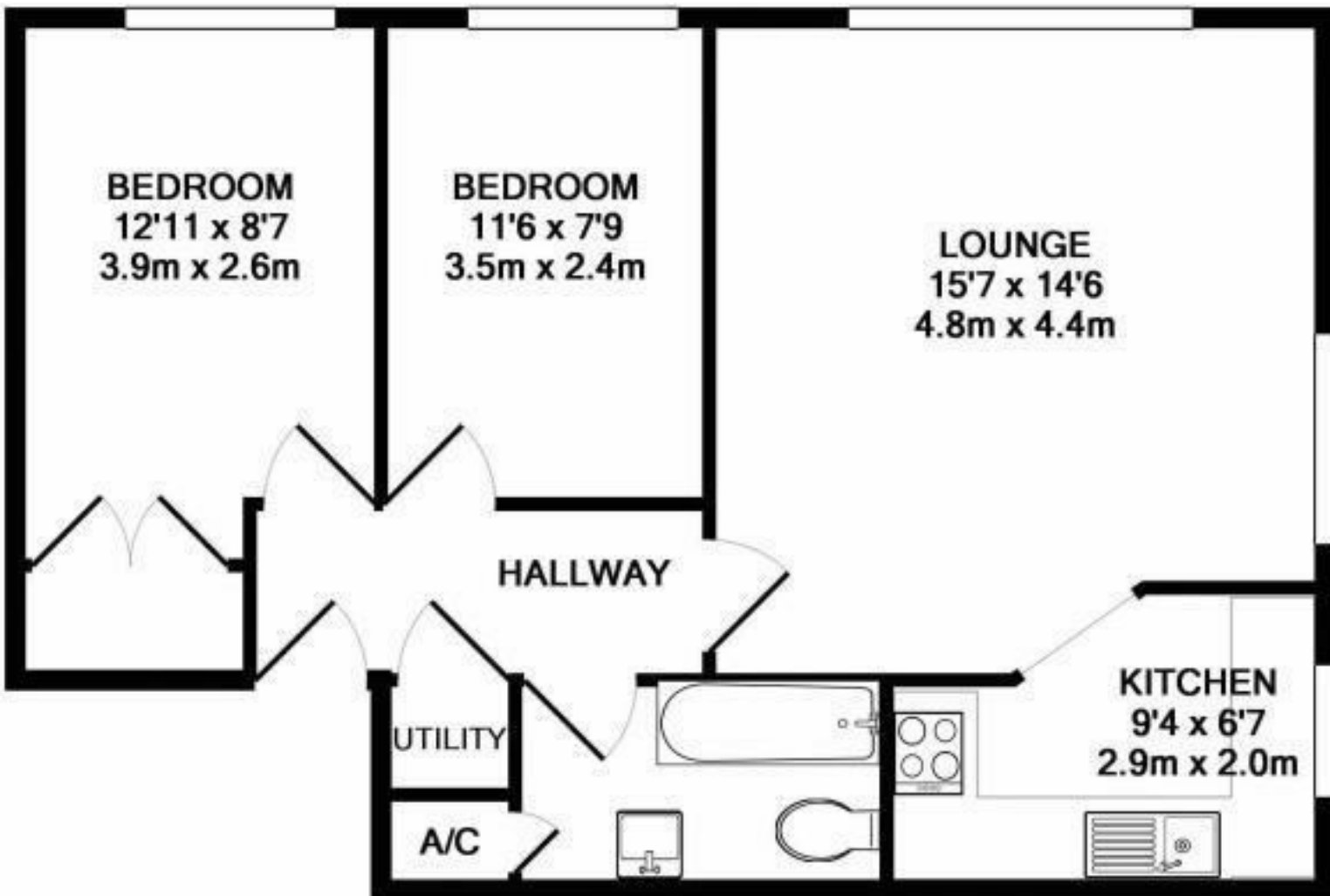

TOTAL APPROX. FLOOR AREA 589 SQ.FT. (54.7 SQ.M.)

Whilst every attempt has been made to ensure the accuracy of the floor plan contained here, measurements of doors, windows, rooms and any other items are approximate and no responsibility is taken for any error, omission, or mis-statement. This plan is for illustrative purposes only and should be used as such by any prospective purchaser. The services, systems and appliances shown have not been tested and no guarantee as to their operability or efficiency can be given

Made with Metropix ©2018

