



Simmons Estates

EST: 1996



6 Sommerville Court, Alconbury Close, Borehamwood, Herts, WD6 4QH £280,000

A two-bedroom first-floor flat situated in a modern development, providing convenient access to the town center, Thameslink mainline station, and local amenities. The property offers spacious bedrooms, a large living area, and a separate kitchen. Additional features include allocated off-street parking and visitor bays. With secure entry and well-maintained communal gardens, this flat is both attractive and desirable.

Please note: This property is owned by an associate of Simmons Estates.



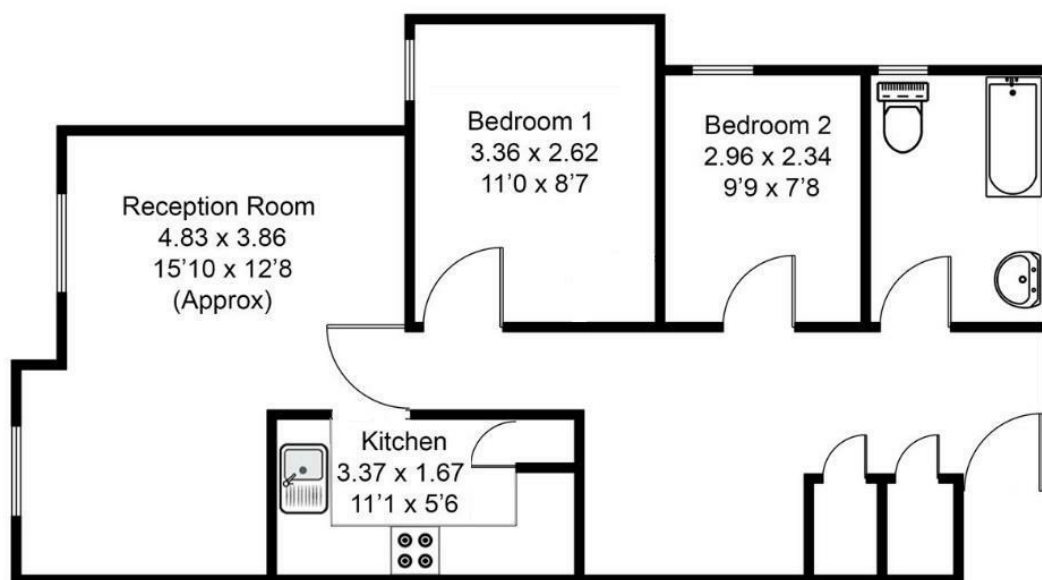

Energy Efficiency Rating		
	Current	Potential
Very energy efficient - lower running costs		
(92 plus) A		
(81-91) B		
(69-80) C	80	80
(55-68) D		
(39-54) E		
(21-38) F		
(1-20) G		
Not energy efficient - higher running costs		
England & Wales EU Directive 2002/91/EC		