

**Curtis & Parker**

211 King Street, Hammersmith, London, W6 9JT

Tel: 020 8741 7100

Email: [home@curtisandparker.co.uk](mailto:home@curtisandparker.co.uk)[www.curtisandparker.co.uk](http://www.curtisandparker.co.uk)

# Curtis & Parker



**First and Second floor flat, 224 King Street, Hammersmith, London, W6 0RA**

**Guide Price £680,000**

Property Description:

Offers in Excess of £699,950

Discover luxury living in this newly refurbished three double bedroom, two bathroom flat, spread across the first and second floors. Completed to a high standard with integrated appliances, this stunning property features:

**Spacious Layout:** Three double bedrooms with fitted wardrobes, providing ample storage.

**Modern Bathrooms:** Two stylish, fully-tiled bathrooms with contemporary fixtures.

**Bright Reception:** A nice and bright reception area, perfect for relaxation and entertaining.

**Open Plan Kitchen:** Modern kitchen with integrated appliances, seamlessly flowing into the living area.

**Large Terrace:** Expansive terrace offering a perfect space for outdoor dining and entertaining.

**Private Garden:** Enjoy the outdoors in your own private garden.

**Modern Decor:** Sleek and contemporary design throughout, with wooden floors and gas central heating.

**Prime Location:** Seconds away from the restaurants, cafes, delis, and supermarkets of Hammersmith and Ravenscourt Park.

**Excellent Transport Links:** Short walk to Ravenscourt Park tube station (District line) and Hammersmith tube station (District, Piccadilly, Circle, and Hammersmith & City lines).

Experience the best of city living in this exceptional flat. Contact us today to arrange a viewing and make this exquisite property your new home.

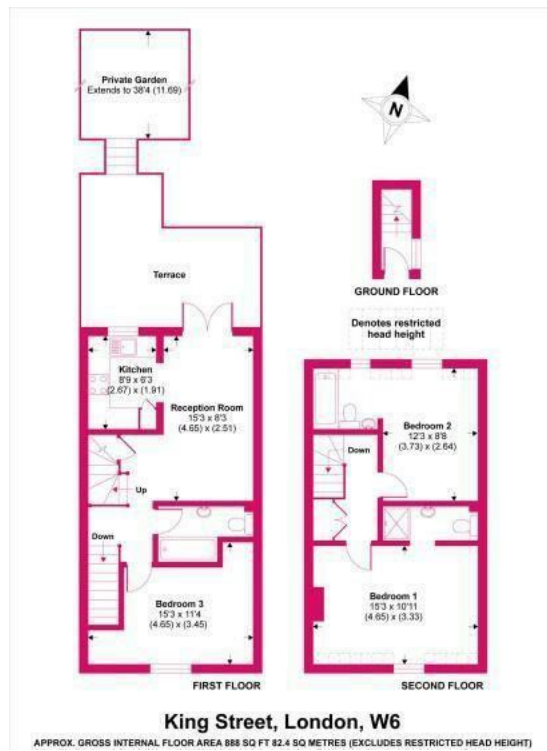

| Energy Efficiency Rating |        | Environmental Impact (CO <sub>2</sub> ) Rating |       |
|--------------------------|--------|--|-------|
| Band                     | Score  | Band   | Score |
| A                        | 92-100 | A  | 35-45 |
| B                        | 81-91  | B  | 26-35 |
| C                        | 69-80  | C  | 21-25 |
| D                        | 55-68  | D  | 16-20 |
| E                        | 49-54  | E  | 11-15 |
| F                        | 39-48  | F  | 6-10  |
| G                        | 35-38  | G  | 1-5   |

England & Wales