

PRIME ESTATES

INDEPENDENT ESTATE AGENTS

Chester Road, Castle Bromwich, Birmingham, B36 0JE

£1,500 Per Month



£1,500 Per Month

Chester Road, Castle Bromwich, Birmingham, B36 0JE

- Available End of September
- Ground Floor
- Main Office Area
- Kitchen
- Outside WC
- Timber Covered Rear Construction
- Small Rear Office/Store Area
- Parking for 2 vehicles to the front

EPC Rating

Current:

Potential:

Council tax band

Band = H

**** AVAILABLE NOW ** FIRST FLOOR **
WC ** KITCHEN AREA ** TWO PARKING
SPACES ****

This FIRST FLOOR commercial space is available now and has the benefit of parking for two vehicles, own entrance door, and window display, two office spaces, one set over two tiers, kitchen area, and a WC. There is a timber storage construction area to the rear of the building. Please call Prime Estates to register your interest.

Parking

Two tandem spaces to the front of the premises

Main Office

Glass fronted office area set over 2 tiers
- rear one being raised

Kitchen

Washing amenities as in sink and drainer

Rear Office/Store

Smaller style office or could be used as a storage area



Timber Construction Store Area

Accessed via the main office area.
Gives access and cover to:-

WC

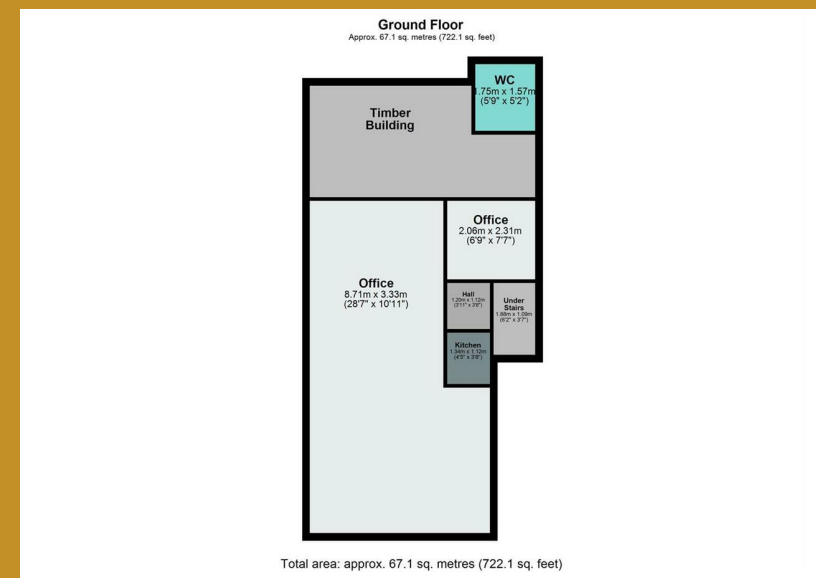
Low flush WC and wash basin area



Energy Efficiency Rating			Environmental Impact (CO ₂) Rating		
	Current	Potential		Current	Potential
Very energy efficient - lower running costs			Very environmentally friendly - lower CO ₂ emissions		
(92 plus) A			(92 plus) A		
(81-91) B			(81-91) B		
(69-80) C			(69-80) C		
(55-68) D			(55-68) D		
(39-54) E			(39-54) E		
(21-38) F			(21-38) F		
(1-20) G			(1-20) G		
Not energy efficient - higher running costs			Not environmentally friendly - higher CO ₂ emissions		
England & Wales		EU Directive 2002/91/EC 	England & Wales		EU Directive 2002/91/EC 

254 Chester Road, Castle Bromwich, B36 0JE
castlebromwich@primeestatesuk.com