



Stag Road, Lordswood, ME5 8LG
Offers in the region of £400,000 Freehold

Located in the popular Lordswood area, this lovely three bedroom detached home offers a wonderful mix of space and contemporary living. Extended to the rear there is plenty of space and outside the plot is generous.

Lordswood has a number of popular schools, doctors' surgery, community centre, along with a selection of shops. Road links are by the nearby M2 and A229. Chatham and Gillingham towns centres are a short drive away and offer all the shops/services of major towns, and mainline train stations with regular services to London and the Coast.

The property's benefits include: a modern fitted kitchen with integrated and built in appliances, extended lounge/diner, three double bedrooms, modern bathroom with white suite, rear garden with side access, driveway and garage with utility area.

VACANT - OFFERED WITH NO ONWARD CHAIN

Entrance hall

Kitchen

11'1 x 6'6 (3.38m x 1.98m)

Cloakroom/WC

6'6 x 2'8 (1.98m x 0.81m)

Lounge/diner

18'4 x 16'8 at widest (5.59m x 5.08m at widest)

Landing

Bedroom one

12'0 x 11'4 (3.66m x 3.45m)

Bedroom two

11'4 x 9'4 (3.45m x 2.84m)

Bedroom three

9'0 x 8'0 (2.74m x 2.44m)

Bathroom

8'3 x 5'10 (2.51m x 1.78m)

Integral garage/utility

17'5 7'9 (5.31m 2.36m)

Rear garden

approx 35' x 25' (approx 10.67m x 7.62m)

Council Tax: BAND D

Tenure: FREEHOLD

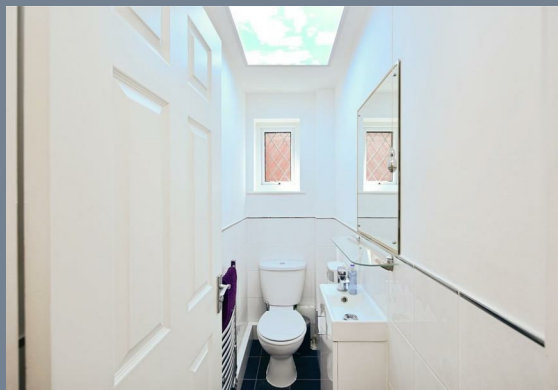



Ground Floor

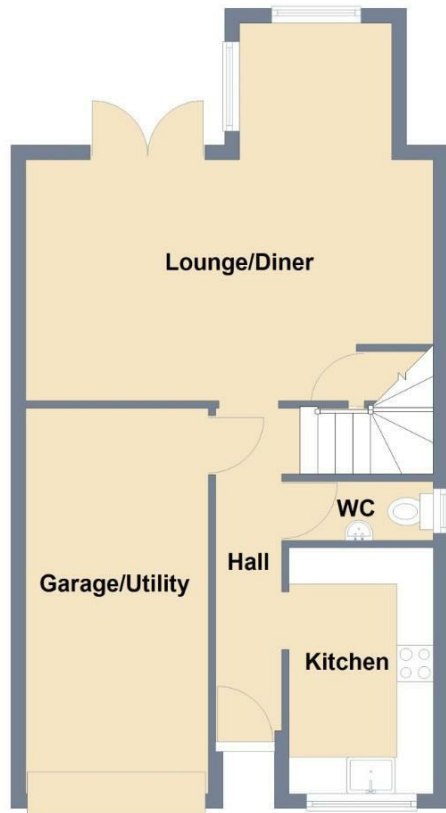

First Floor



Total area: approx. 93.3 sq. metres (1004.3 sq. feet)

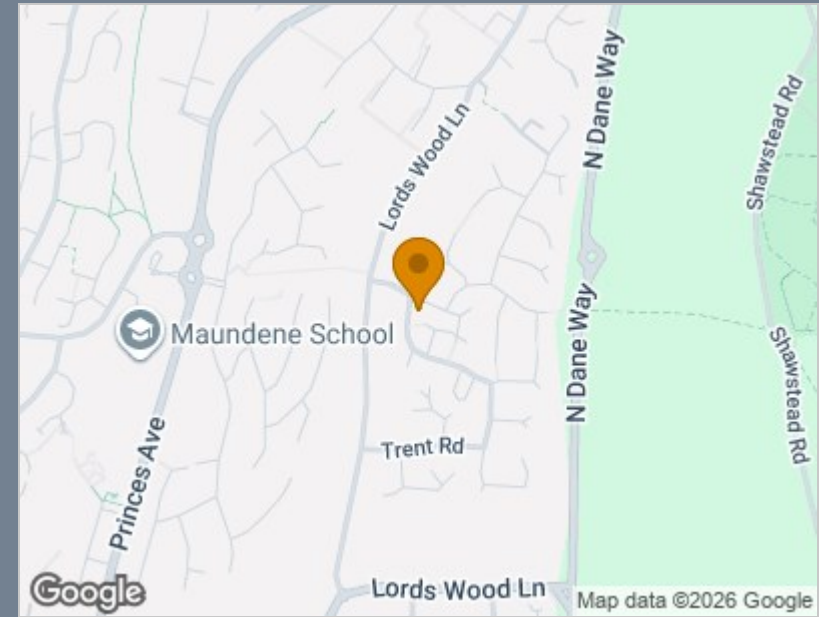

Energy Efficiency Rating		Current	Potential
Very energy efficient - lower running costs			
(92 plus) A			
(81-91) B			
(69-80) C		76	85
(55-68) D			
(39-54) E			
(21-38) F			
(1-20) G			
Not energy efficient - higher running costs			
England & Wales	EU Directive 2002/91/EC		

Viewing

Please contact The Homes Group Office on 01322 875000 if you wish to arrange a viewing appointment for this property or require further information.

These particulars, whilst believed to be accurate are set out as a general outline only for guidance and do not constitute any part of an offer or contract. Intending purchasers should not rely on them as statements of representation of fact, but must satisfy themselves by inspection or otherwise as to their accuracy. No person in this firm's employment has the authority to make or give any representation or warranty in respect of the property.